

LOT 502, WATALONG WAY EDGEWORTH

MASTER PLAN



STAGE PLAN



PRELIMINARY SITE ANALYSIS PLAN

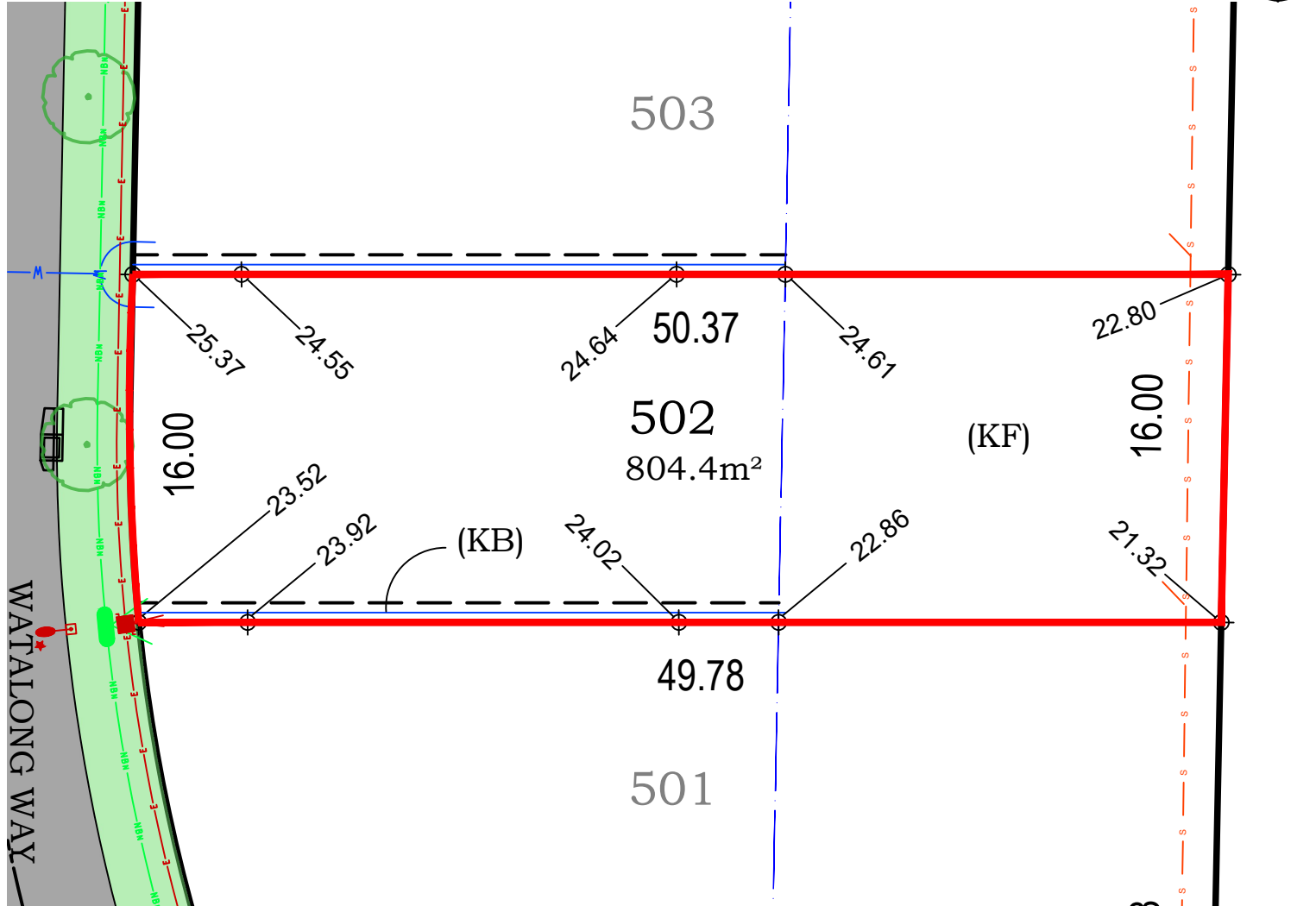

DISCLAIMER/ NOTES:

1. Contours are based on finished design levels and are subject to construction and Council certification and therefore should not be considered as final or as-built.
2. Location of utility services including but not limited to power, water, sewer, communications and gas are subject to construction and supply authority certification and therefore should not be considered as final or as-built.
3. Survey information such as boundary dimensions and areas, easements etc are subject to final survey. Purchasers should refer to the deposited plan and 88B instrument contained in the contract for sale of land for further detailed information.
4. Bushfire and geotechnical classification are provided for convenience. Purchasers should refer to referenced detail specialist reports.
5. This preliminary site analysis plan has been collated from various sources of design information and is provided for convenience to assist purchasers in obtaining quotations/ tenders for dwelling construction.
6. This document does not form part of the contract of sale of the land.
7. Anticipated site classification - H1 class (to be confirmed at completion of construction).

(KA) - EASEMENT TO DRAIN WATER 2 WIDE
 (KB) - RESTRICTION ON THE USE OF LAND 0.9 WIDE
 (KC) - EASEMENT FOR SIGNAGE 1.5 WIDE
 (KD) - EASEMENT FOR PUBLIC ART 2.5 WIDE
 (KF) - ASSET PROTECTION EASEMENT 20 WIDE

REVISION/S: HD27 STAGE 5 MARKETING r1
 DATE: 20th May 2020
 BY: ACOR CONSULTANTS PTY LTD

LOT 503, WATALONG WAY EDGEWORTH

MASTER PLAN



STAGE PLAN



BRUSH CREEK
— LAKE MACQUARIE —

PRELIMINARY SITE ANALYSIS PLAN

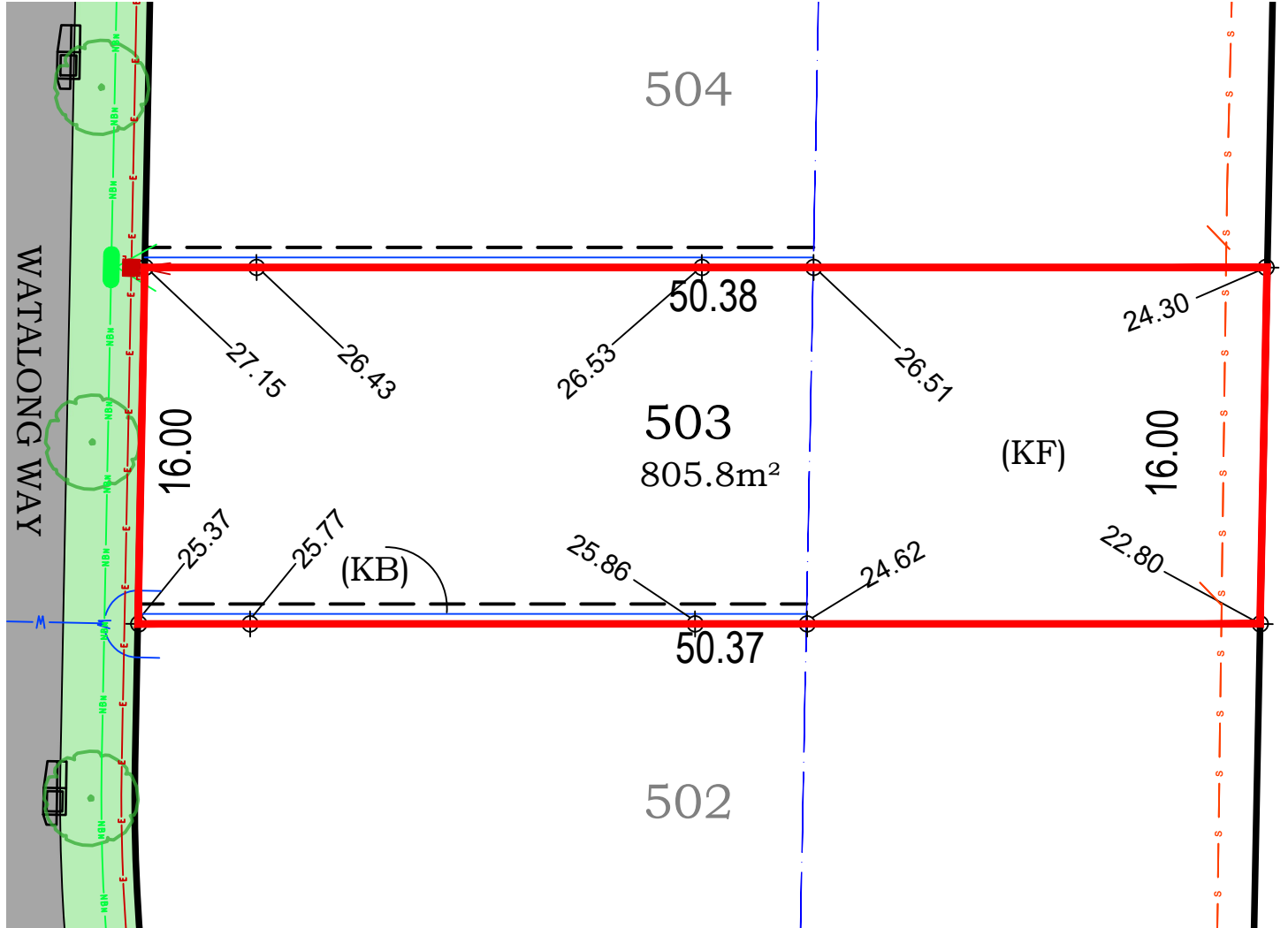

LEGEND:

- BATTER INTERFACE
- RETAINING WALL
- STORMWATER PIT
- SV — STORMWATER PIPE
- S — SEWERMAIN
- S — SEWER MAINTENANCE STRUCTURE
- S — SEWER JUNCTION
- W — WATERMAIN
- O X — HYDRANT, STOP VALVE
- NBN — TELSTRA/ NBN
- NBN — TELSTRA/ NBN PIT
- E — UNDER GROUND POWER
- E — ELECTRICITY PILLAR
- E — ELECTRICAL SUBSTATION
- E — ELECTRICAL EASEMENT
- E — LIGHT POLE
- R — RESTRICTION ON THE USE OF LAND 0.9 WIDE
- S — STREET TREES
- A — ASSET PROTECTION ZONE BDY

DISCLAIMER/ NOTES:

- Contours are based on finished design levels and are subject to construction and Council certification and therefore should not be considered as final or as-built.
- location of utility services including but not limited to power, water, sewer, communications and gas are subject to construction and supply authority certification and therefore should not be considered as final or as-built.
- survey information such as boundary dimensions and areas, easements etc are subject to final survey. Purchasers should refer to the deposited plan and 88B instrument contained in the contract for sale of land for further detailed information.
- Bushfire and geotechnical classification are provided for convenience. Purchasers should refer to referenced detail specialist reports.
- This preliminary site analysis plan has been collated from various sources of design information and is provided for convenience to assist purchasers in obtaining quotations/ tenders for dwelling construction.
- This document does not form part of the contract of sale of the land.
- Anticipated site classification - H1 class (to be confirmed at completion of construction).

(KA) - EASEMENT TO DRAIN WATER 2 WIDE
(KB) - RESTRICTION ON THE USE OF LAND 0.9 WIDE
(KC) - EASEMENT FOR SIGNAGE 1.5 WIDE
(KD) - EASEMENT FOR PUBLIC ART 2.5 WIDE
(KF) - ASSET PROTECTION EASEMENT 20 WIDE

REVISION/S: HD27 STAGE 5 MARKETING r1
DATE: 20th May 2020
BY: ACOR CONSULTANTS PTY LTD

brushcreek.com.au



A QUALITY
MCCLOY
GROUP
PROJECT

LOT 504, WATALONG WAY EDGEWORTH



BRUSH CREEK
— LAKE MACQUARIE —

MASTER PLAN



STAGE PLAN



PRELIMINARY SITE ANALYSIS PLAN

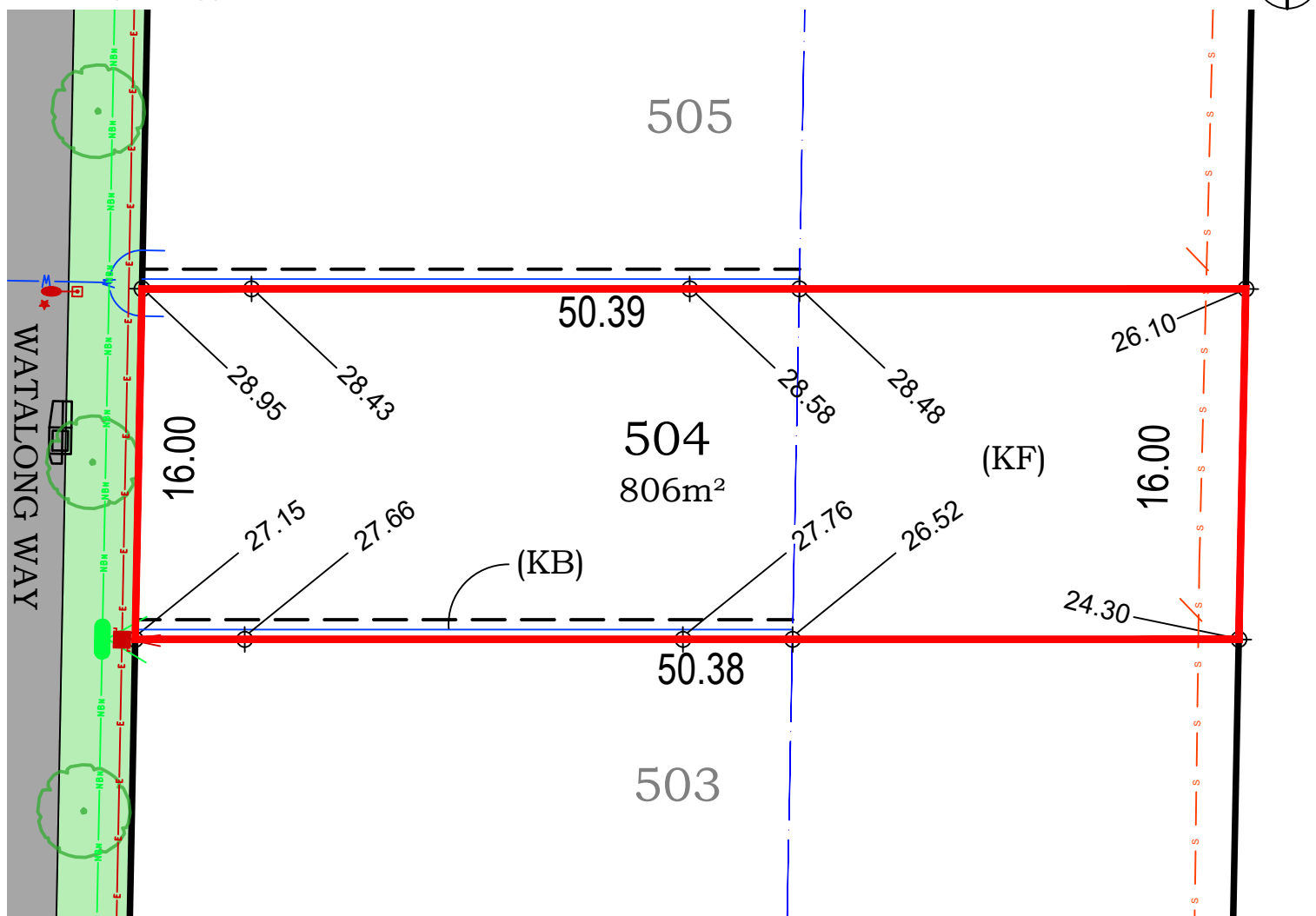

LEGEND:

- BATTER INTERFACE
- RETAINING WALL
- STORMWATER PIT
- SV — STORMWATER PIPE
- S — SEWERMAIN
- S — SEWER MAINTENANCE STRUCTURE
- S — SEWER JUNCTION
- W — WATERMAIN
- O X — HYDRANT, STOP VALVE
- NBN — TELSTRA/ NBN
- NBN — TELSTRA/ NBN PIT
- E — UNDER GROUND POWER
- E — ELECTRICITY PILLAR
- E — ELECTRICAL SUBSTATION
- E — ELECTRICAL EASEMENT
- E — LIGHT POLE
- R — RESTRICTION ON THE USE OF LAND 0.9 WIDE
- S — STREET TREES
- A — ASSET PROTECTION ZONE BDY

DISCLAIMER/ NOTES:

- Contours are based on finished design levels and are subject to construction and Council certification and therefore should not be considered as final or as-built.
- location of utility services including but not limited to power, water, sewer, communications and gas are subject to construction and supply authority certification and therefore should not be considered as final or as-built.
- survey information such as boundary dimensions and areas, easements etc are subject to final survey. Purchasers should refer to the deposited plan and 88B instrument contained in the contract for sale of land for further detailed information.
- Bushfire and geotechnical classification are provided for convenience. Purchasers should refer to referenced detail specialist reports.
- This preliminary site analysis plan has been collated from various sources of design information and is provided for convenience to assist purchasers in obtaining quotations/ tenders for dwelling construction.
- This document does not form part of the contract of sale of the land.
- Anticipated site classification - H1 class (to be confirmed at completion of construction).

(KA) - EASEMENT TO DRAIN WATER 2 WIDE
(KB) - RESTRICTION ON THE USE OF LAND 0.9 WIDE
(KC) - EASEMENT FOR SIGNAGE 1.5 WIDE
(KD) - EASEMENT FOR PUBLIC ART 2.5 WIDE
(KF) - ASSET PROTECTION EASEMENT 20 WIDE

REVISION/S: HD27 STAGE 5 MARKETING r1
DATE: 26th May 2020
BY: ACOR CONSULTANTS PTY LTD

brushcreek.com.au



LOT 505, WATALONG WAY EDGEWORTH



BRUSH CREEK
— LAKE MACQUARIE —

MASTER PLAN



STAGE PLAN



PRELIMINARY SITE ANALYSIS PLAN

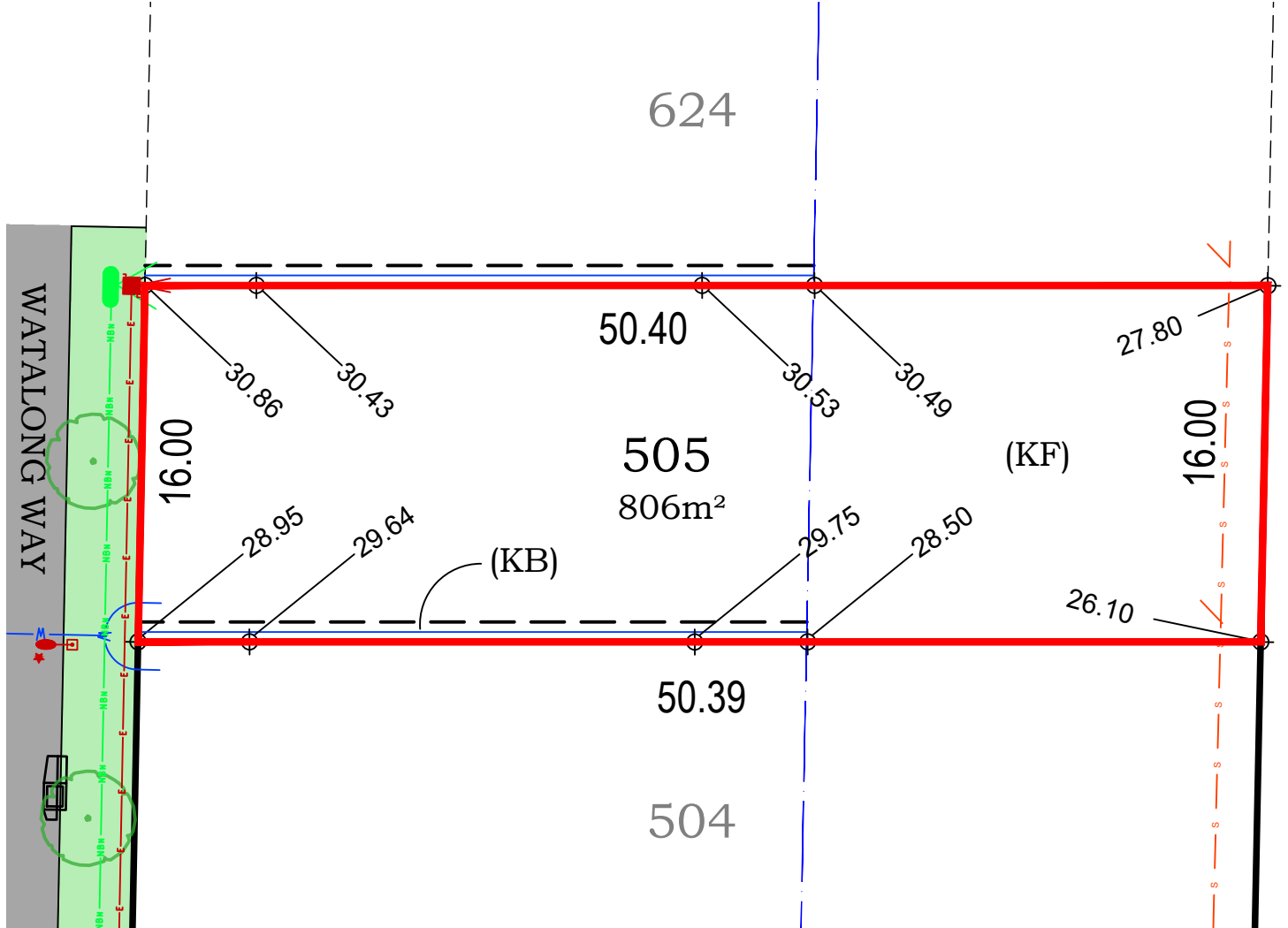

LEGEND:

- BATTER INTERFACE
- RETAINING WALL
- STORMWATER PIT
- SV — STORMWATER PIPE
- S — SEWERMAIN
- S — SEWER MAINTENANCE STRUCTURE
- S — SEWER JUNCTION
- W — WATERMAIN
- O X — HYDRANT, STOP VALVE
- NBN — TELSTRA/ NBN
- NBN — TELSTRA/ NBN PIT
- E — UNDER GROUND POWER
- E — ELECTRICITY PILLAR
- E — ELECTRICAL SUBSTATION
- E — ELECTRICAL EASEMENT
- E — LIGHT POLE
- E — RESTRICTION ON THE USE OF LAND 0.9 WIDE
- E — STREET TREES
- E — ASSET PROTECTION ZONE BDY

DISCLAIMER/ NOTES:

- Contours are based on finished design levels and are subject to construction and Council certification and therefore should not be considered as final or as-built.
- Location of utility services including but not limited to power, water, sewer, communications and gas are subject to construction and supply authority certification and therefore should not be considered as final or as-built.
- Survey information such as boundary dimensions and areas, easements etc are subject to final survey. Purchasers should refer to the deposited plan and 88B instrument contained in the contract for sale of land for further detailed information.
- Bushfire and geotechnical classification are provided for convenience. Purchasers should refer to referenced detail specialist reports.
- This preliminary site analysis plan has been collated from various sources of design information and is provided for convenience to assist purchasers in obtaining quotations/ tenders for dwelling construction.
- This document does not form part of the contract of sale of the land.
- Anticipated site classification - H1 class (to be confirmed at completion of construction).

(KA) - EASEMENT TO DRAIN WATER 2 WIDE
(KB) - RESTRICTION ON THE USE OF LAND 0.9 WIDE
(KC) - EASEMENT FOR SIGNAGE 1.5 WIDE
(KD) - EASEMENT FOR PUBLIC ART 2.5 WIDE
(KF) - ASSET PROTECTION EASEMENT 20 WIDE

REVISION/S: HD27 STAGE 5 MARKETING r1
DATE: 26th May 2020
BY: ACOR CONSULTANTS PTY LTD

brushcreek.com.au



LOT 507, WATALONG WAY EDGEWORTH



BRUSH CREEK
— LAKE MACQUARIE —

MASTER PLAN



STAGE PLAN



PRELIMINARY SITE ANALYSIS PLAN

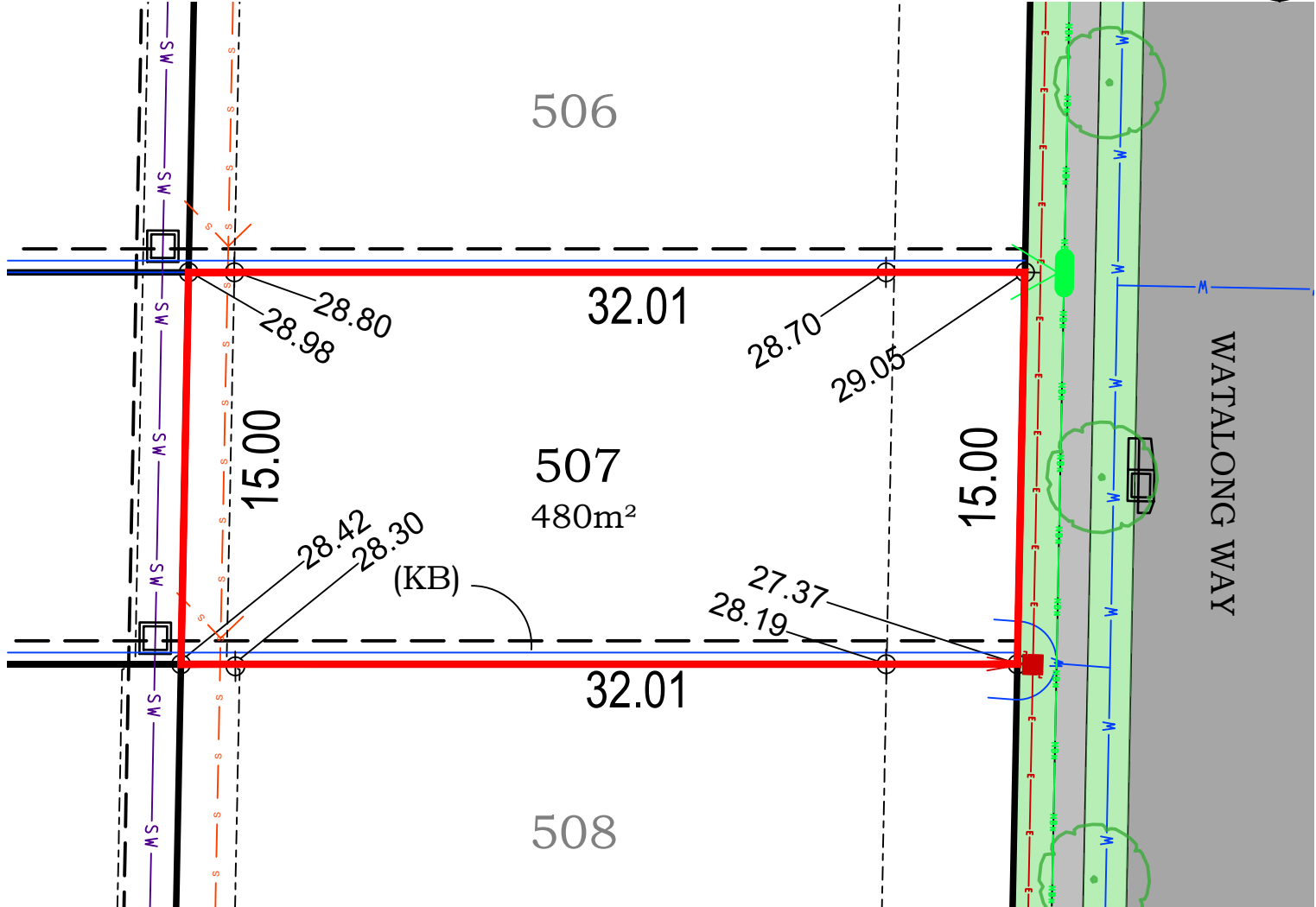

LEGEND:

- BATTER INTERFACE
- RETAINING WALL
- STORMWATER PIT
- SV — STORMWATER PIPE
- S — SEWERMAIN
- S — SEWER MAINTENANCE STRUCTURE
- S — SEWER JUNCTION
- W — WATERMAIN
- O X — HYDRANT, STOP VALVE
- NBN — TELSTRA/ NBN
- NBN — TELSTRA/ NBN PIT
- E — UNDER GROUND POWER
- E — ELECTRICITY PILLAR
- E — ELECTRICAL SUBSTATION
- E — ELECTRICAL EASEMENT
- E — LIGHT POLE
- R — RESTRICTION ON THE USE OF LAND 0.9 WIDE
- S — STREET TREES
- A — ASSET PROTECTION ZONE BDY

DISCLAIMER/ NOTES:

1. Contours are based on finished design levels and are subject to construction and Council certification and therefore should not be considered as final or as-built.
2. location of utility services including but not limited to power, water, sewer, communications and gas are subject to construction and supply authority certification and therefore should not be considered as final or as-built.
3. survey information such as boundary dimensions and areas, easements etc are subject to final survey. Purchasers should refer to the deposited plan and 88B instrument contained in the contract for sale of land for further detailed information.
4. Bushfire and geotechnical classification are provided for convenience. Purchasers should refer to referenced detail specialist reports.
5. This preliminary site analysis plan has been collated from various sources of design information and is provided for convenience to assist purchasers in obtaining quotations/ tenders for dwelling construction.
6. This document does not form part of the contract of sale of the land.
7. Anticipated site classification - H1 class (to be confirmed at completion of construction).

(KA) - EASEMENT TO DRAIN WATER 2 WIDE
(KB) - RESTRICTION ON THE USE OF LAND 0.9 WIDE
(KC) - EASEMENT FOR SIGNAGE 1.5 WIDE
(KD) - EASEMENT FOR PUBLIC ART 2.5 WIDE
(KF) - ASSET PROTECTION EASEMENT 20 WIDE

REVISION/S: HD27 STAGE 5 MARKETING r1
DATE: 26th May 2020
BY: ACOR CONSULTANTS PTY LTD

brushcreek.com.au



LOT 508, WATALONG WAY EDGEWORTH



BRUSH CREEK
— LAKE MACQUARIE —

MASTER PLAN



STAGE PLAN



PRELIMINARY SITE ANALYSIS PLAN

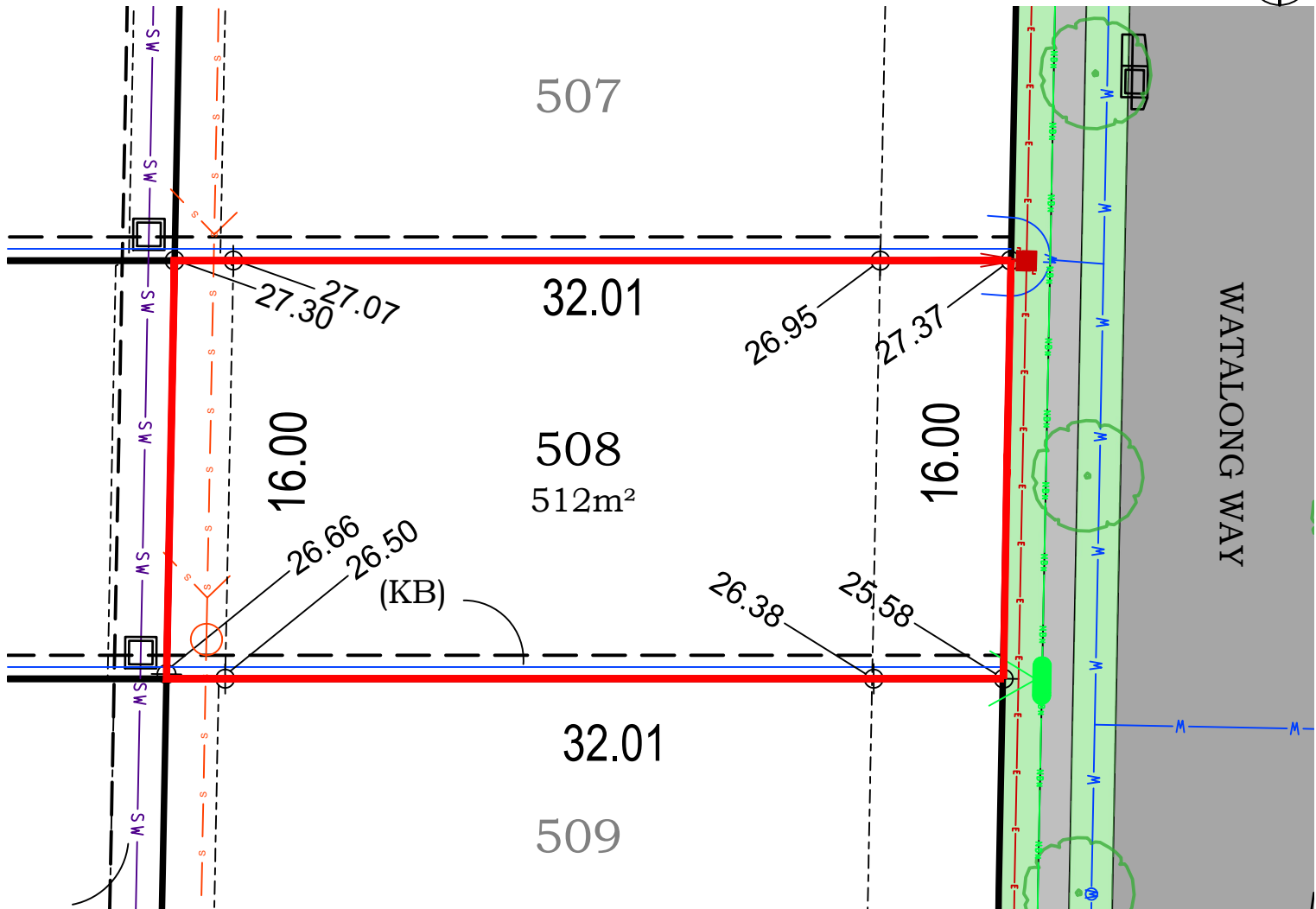

LEGEND:

- BATTER INTERFACE
- RETAINING WALL
- STORMWATER PIT
- SV --- STORMWATER PIPE
- S --- SEWERMAIN
- O --- SEWER MAINTENANCE STRUCTURE
- S --- SEWER JUNCTION
- W --- WATERMAIN
- O X --- HYDRANT, STOP VALVE
- NBN --- TELSTRA/ NBN
- NBN PIT --- TELSTRA/ NBN PIT
- E --- UNDER GROUND POWER
- E --- ELECTRICITY PILLAR
- E --- ELECTRICAL SUBSTATION
- E --- ELECTRICAL EASEMENT
- E --- LIGHT POLE
- RESTRICTION ON THE USE OF LAND 0.9 WIDE
- STREET TREES
- ASSET PROTECTION ZONE BDY

DISCLAIMER/ NOTES:

1. Contours are based on finished design levels and are subject to construction and Council certification and therefore should not be considered as final or as-built.
2. location of utility services including but not limited to power, water, sewer, communications and gas are subject to construction and supply authority certification and therefore should not be considered as final or as-built.
3. survey information such as boundary dimensions and areas, easements etc are subject to final survey. Purchasers should refer to the deposited plan and 88B instrument contained in the contract for sale of land for further detailed information.
4. Bushfire and geotechnical classification are provided for convenience. Purchasers should refer to referenced detail specialist reports.
5. This preliminary site analysis plan has been collated from various sources of design information and is provided for convenience to assist purchasers in obtaining quotations/ tenders for dwelling construction.
6. This document does not form part of the contract of sale of the land.
7. Anticipated site classification - H1 class (to be confirmed at completion of construction).

(KA) - EASEMENT TO DRAIN WATER 2 WIDE
(KB) - RESTRICTION ON THE USE OF LAND 0.9 WIDE
(KC) - EASEMENT FOR SIGNAGE 1.5 WIDE
(KD) - EASEMENT FOR PUBLIC ART 2.5 WIDE
(KF) - ASSET PROTECTION EASEMENT 20 WIDE

REVISION/S: HD27 STAGE 5 MARKETING r1
DATE: 20th May 2020
BY: ACOR CONSULTANTS PTY LTD

brushcreek.com.au



LOT 509, WATALONG WAY EDGEWORTH



BRUSH CREEK
— LAKE MACQUARIE —

MASTER PLAN



STAGE PLAN



PRELIMINARY SITE ANALYSIS PLAN

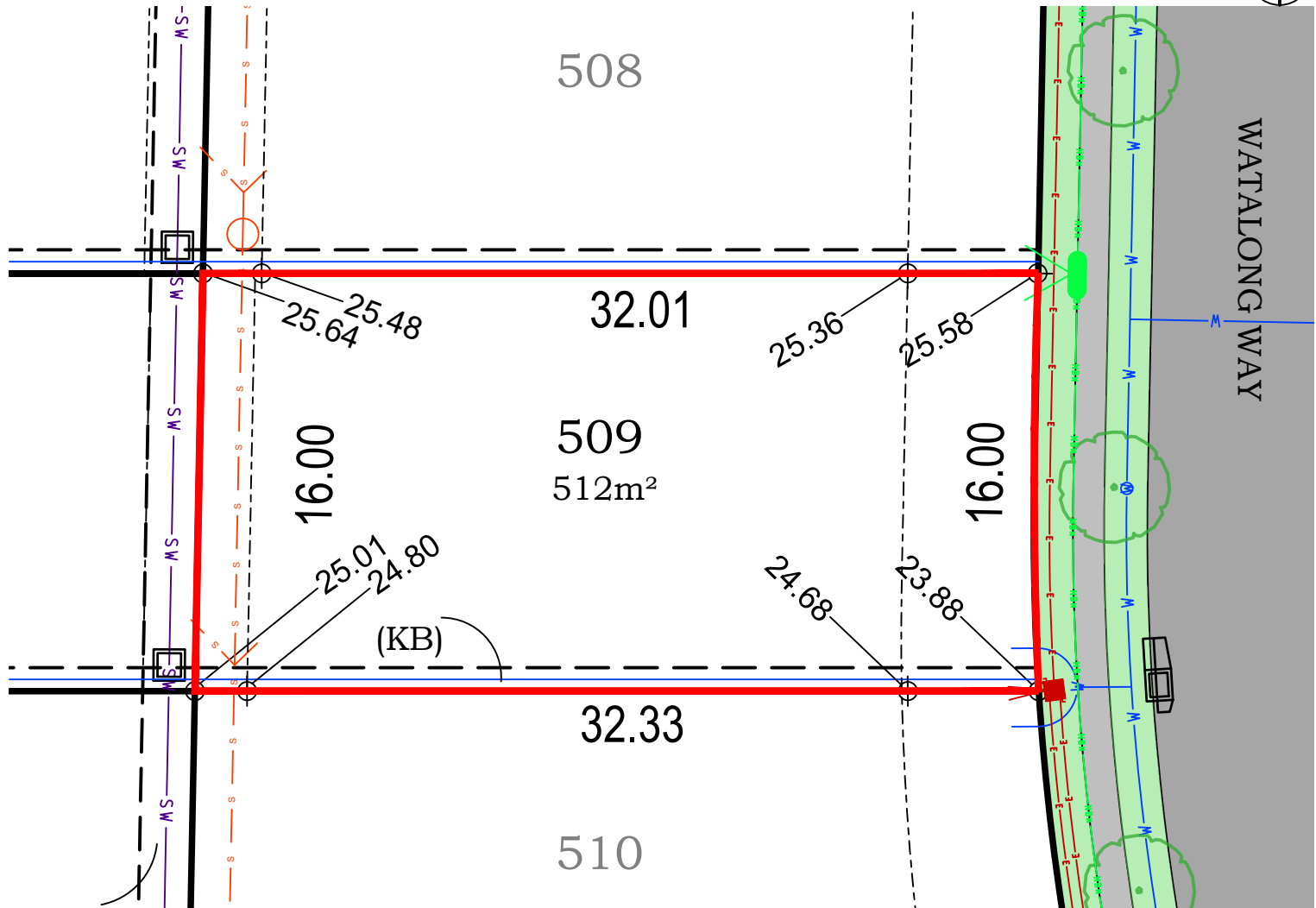

LEGEND:

- BATTER INTERFACE
- RETAINING WALL
- STORMWATER PIT
- SV --- STORMWATER PIPE
- S --- SEWERMAIN
- O --- SEWER MAINTENANCE STRUCTURE
- S --- SEWER JUNCTION
- W --- WATERMAIN
- O X --- HYDRANT, STOP VALVE
- NBN --- TELSTRA/ NBN
- NBN PIT --- TELSTRA/ NBN PIT
- E --- UNDER GROUND POWER
- E --- ELECTRICITY PILLAR
- E --- ELECTRICAL SUBSTATION
- E --- ELECTRICAL EASEMENT
- E --- LIGHT POLE
- E --- RESTRICTION ON THE USE OF LAND 0.9 WIDE
- S --- STREET TREES
- S --- ASSET PROTECTION ZONE BDY

DISCLAIMER/ NOTES:

1. Contours are based on finished design levels and are subject to construction and Council certification and therefore should not be considered as final or as-built.
2. location of utility services including but not limited to power, water, sewer, communications and gas are subject to construction and supply authority certification and therefore should not be considered as final or as-built.
3. survey information such as boundary dimensions and areas, easements etc are subject to final survey. Purchasers should refer to the deposited plan and 88B instrument contained in the contract for sale of land for further detailed information.
4. Bushfire and geotechnical classification are provided for convenience. Purchasers should refer to referenced detail specialist reports.
5. This preliminary site analysis plan has been collated from various sources of design information and is provided for convenience to assist purchasers in obtaining quotations/ tenders for dwelling construction.
6. This document does not form part of the contract of sale of the land.
7. Anticipated site classification - H1 class (to be confirmed at completion of construction).

(KA) - EASEMENT TO DRAIN WATER 2 WIDE
(KB) - RESTRICTION ON THE USE OF LAND 0.9 WIDE
(KC) - EASEMENT FOR SIGNAGE 1.5 WIDE
(KD) - EASEMENT FOR PUBLIC ART 2.5 WIDE
(KF) - ASSET PROTECTION EASEMENT 20 WIDE

REVISION/S: HD27 STAGE 5 MARKETING r1
DATE: 20th May 2020
BY: ACOR CONSULTANTS PTY LTD

brushcreek.com.au



LOT 510, WATALONG WAY EDGEWORTH



BRUSH CREEK
— LAKE MACQUARIE —

MASTER PLAN



STAGE PLAN



PRELIMINARY SITE ANALYSIS PLAN

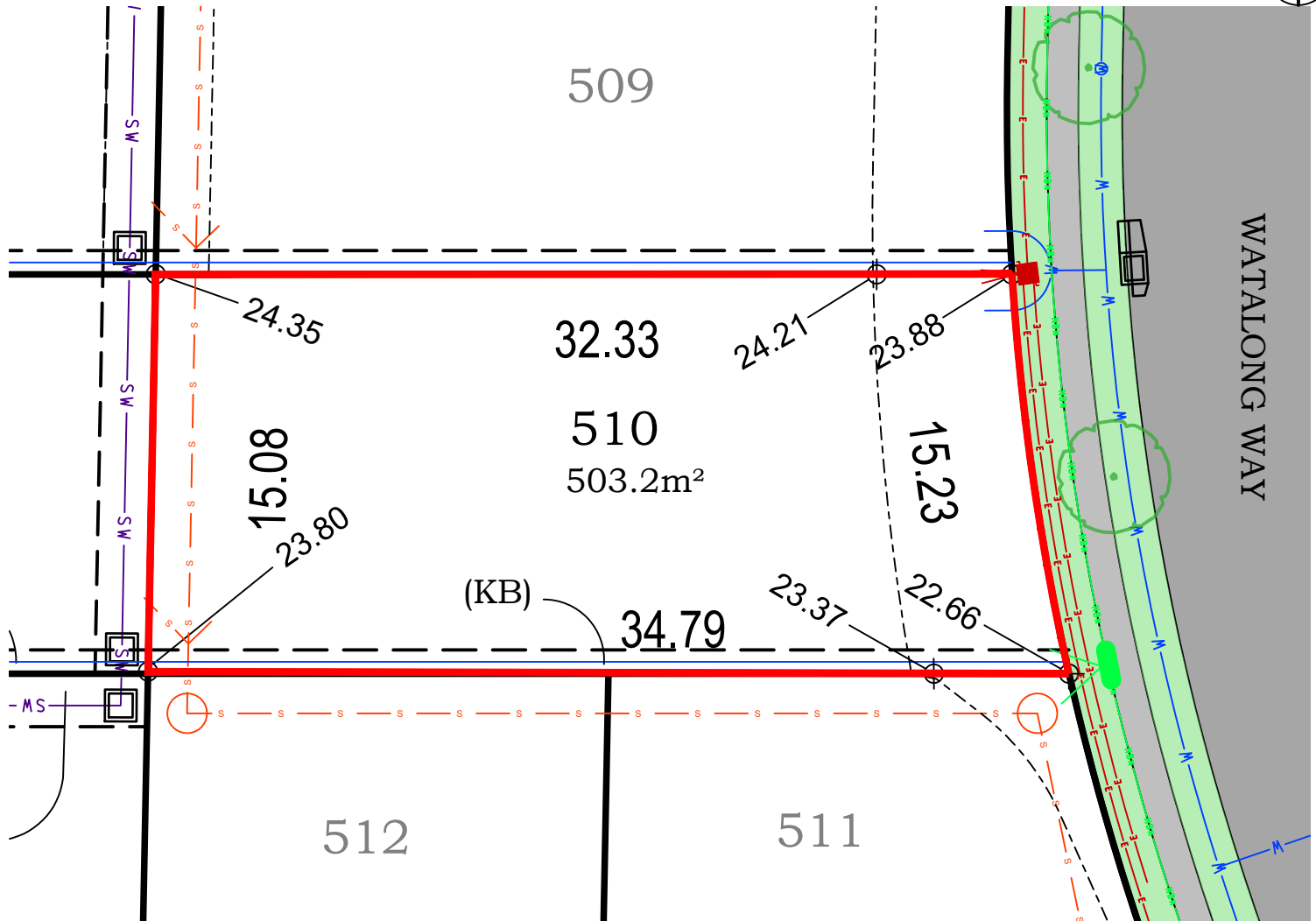

LEGEND:

- BATTER INTERFACE
- RETAINING WALL
- STORMWATER PIT
- SV --- STORMWATER PIPE
- S --- SEWERMAIN
- S --- SEWER MAINTENANCE STRUCTURE
- S --- SEWER JUNCTION
- W --- WATERMAIN
- O X --- HYDRANT, STOP VALVE
- NBW --- TELSTRA/ NBN
- TELSTRA/ NBN PIT
- E --- UNDER GROUND POWER
- E --- ELECTRICITY PILLAR
- E --- ELECTRICAL SUBSTATION
- E --- ELECTRICAL EASEMENT
- E --- LIGHT POLE
- RESTRICTION ON THE USE OF LAND 0.9 WIDE
- STREET TREES
- ASSET PROTECTION ZONE BDY

DISCLAIMER/ NOTES:

1. Contours are based on finished design levels and are subject to construction and Council certification and therefore should not be considered as final or as-built.
2. location of utility services including but not limited to power, water, sewer, communications and gas are subject to construction and supply authority certification and therefore should not be considered as final or as-built.
3. survey information such as boundary dimensions and areas, easements etc are subject to final survey. Purchasers should refer to the deposited plan and 88B instrument contained in the contract for sale of land for further detailed information.
4. Bushfire and geotechnical classification are provided for convenience. Purchasers should refer to referenced detail specialist reports.
5. This preliminary site analysis plan has been collated from various sources of design information and is provided for convenience to assist purchasers in obtaining quotations/ tenders for dwelling construction.
6. This document does not form part of the contract of sale of the land.
7. Anticipated site classification - H1 class (to be confirmed at completion of construction).

(KA) - EASEMENT TO DRAIN WATER 2 WIDE
(KB) - RESTRICTION ON THE USE OF LAND 0.9 WIDE
(KC) - EASEMENT FOR SIGNAGE 1.5 WIDE
(KD) - EASEMENT FOR PUBLIC ART 2.5 WIDE
(KF) - ASSET PROTECTION EASEMENT 20 WIDE

REVISION/S: HD27 STAGE 5 MARKETING r1
DATE: 20th May 2020
BY: ACOR CONSULTANTS PTY LTD

brushcreek.com.au





MASTER PLAN



STAGE PLAN



PRELIMINARY SITE ANALYSIS PLAN

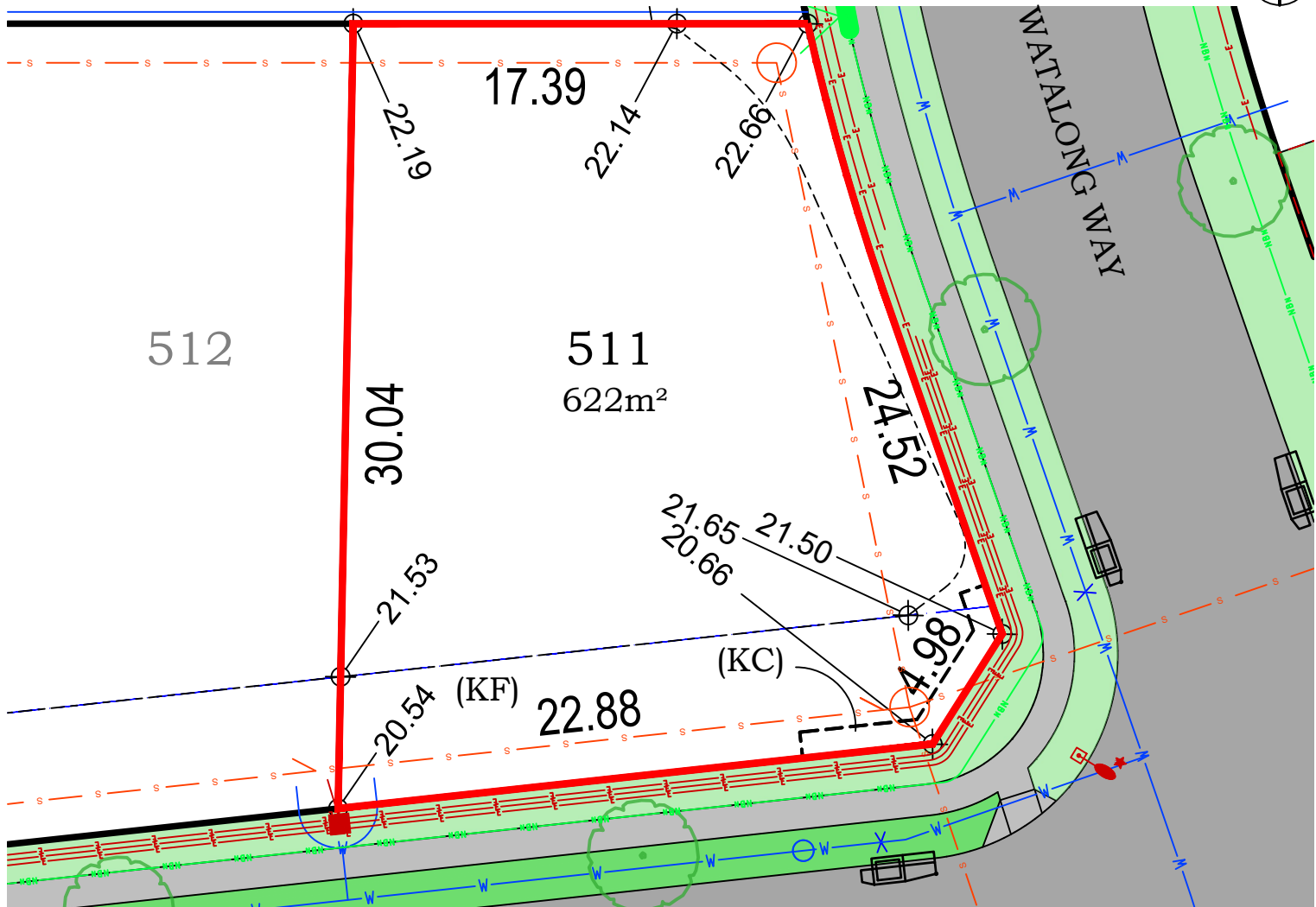

LEGEND:

- BATTER INTERFACE
- RETAINING WALL
- STORMWATER PIT
- SV --- STORMWATER PIPE
- S --- SEWERMAIN
- O --- SEWER MAINTENANCE STRUCTURE
- S --- SEWER JUNCTION
- W --- WATERMAIN
- O X --- HYDRANT, STOP VALVE
- NBN --- TELSTRA/ NBN
- TELSTRA/ NBN PIT
- E --- UNDER GROUND POWER
- P --- ELECTRICITY PILLAR
- E --- ELECTRICAL SUBSTATION
- E --- ELECTRICAL EASEMENT
- P --- LIGHT POLE
- R --- RESTRICTION ON THE USE OF LAND 0.9 WIDE
- S --- STREET TREES
- A --- ASSET PROTECTION ZONE BDY

DISCLAIMER/ NOTES:

1. Contours are based on finished design levels and are subject to construction and Council certification and therefore should not be considered as final or as-built.
2. location of utility services including but not limited to power, water, sewer, communications and gas are subject to construction and supply authority certification and therefore should not be considered as final or as-built.
3. survey information such as boundary dimensions and areas, easements etc are subject to final survey. Purchasers should refer to the deposited plan and 88B instrument contained in the contract for sale of land for further detailed information.
4. Bushfire and geotechnical classification are provided for convenience. Purchasers should refer to referenced detail specialist reports.
5. This preliminary site analysis plan has been collated from various sources of design information and is provided for convenience to assist purchasers in obtaining quotations/ tenders for dwelling construction.
6. This document does not form part of the contract of sale of the land.
7. Anticipated site classification - H1 class (to be confirmed at completion of construction).

(KA) - EASEMENT TO DRAIN WATER 2 WIDE
 (KB) - RESTRICTION ON THE USE OF LAND 0.9 WIDE
 (KC) - EASEMENT FOR SIGNAGE 1.5 WIDE
 (KD) - EASEMENT FOR PUBLIC ART 2.5 WIDE
 (KF) - ASSET PROTECTION EASEMENT 5 WIDE

REVISION/S: HD27 STAGE 5 MARKETING r1

DATE: 20th May 2020

BY: ACOR CONSULTANTS PTY LTD



MASTER PLAN



STAGE PLAN



PRELIMINARY SITE ANALYSIS PLAN

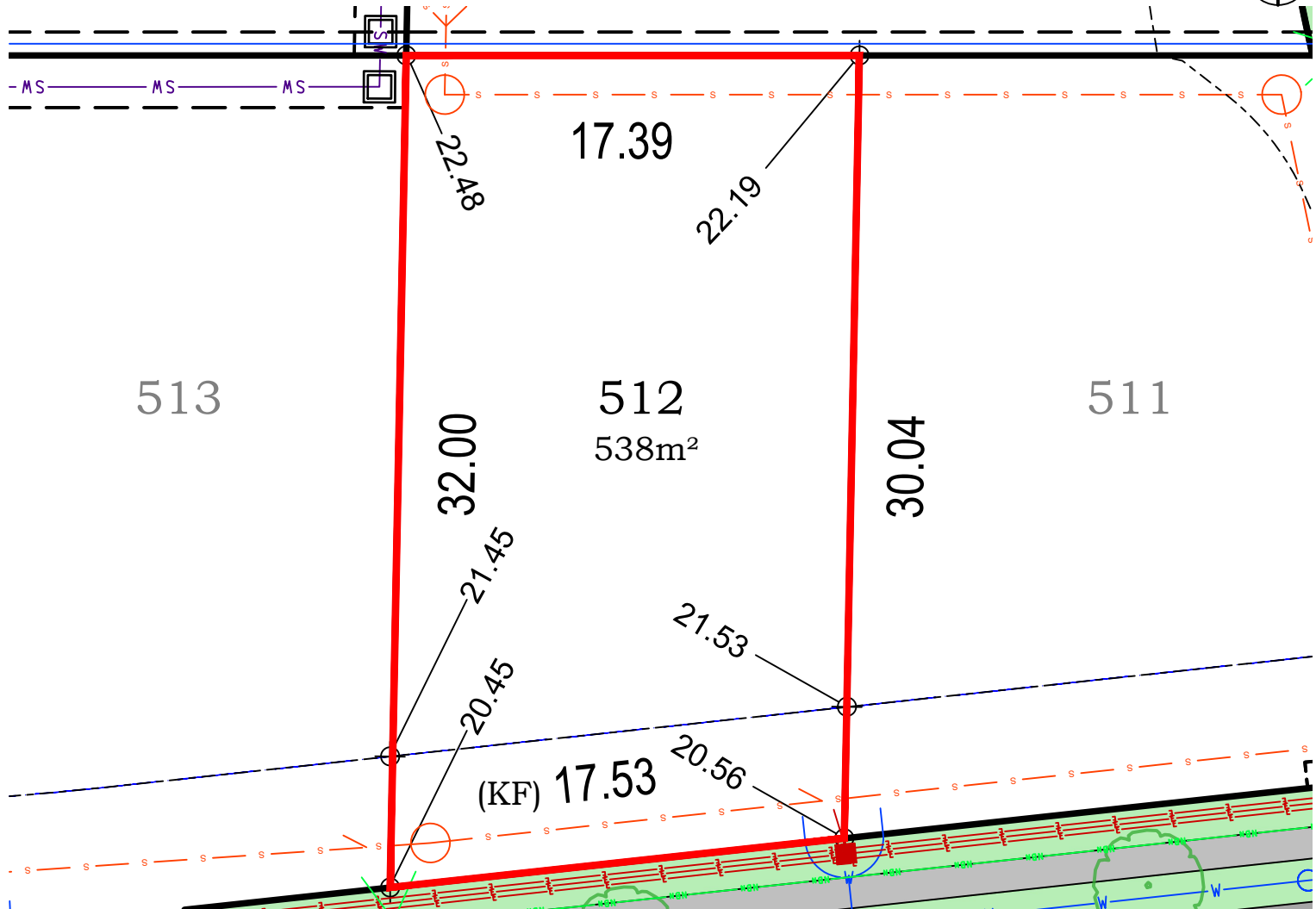

LEGEND:

- BATTER INTERFACE
- RETAINING WALL
- STORMWATER PIT
- SV --- STORMWATER PIPE
- S --- SEWERMAIN
- O --- SEWER MAINTENANCE STRUCTURE
- S --- SEWER JUNCTION
- W --- WATERMAIN
- O X --- HYDRANT, STOP VALVE
- NBN --- TELSTRA/ NBN
- TELSTRA/ NBN PIT
- E --- UNDER GROUND POWER
- E --- ELECTRICITY PILLAR
- E --- ELECTRICAL SUBSTATION
- E --- ELECTRICAL EASEMENT
- E --- LIGHT POLE
- RESTRICTION ON THE USE OF LAND 0.9 WIDE
- STREET TREES
- ASSET PROTECTION ZONE BDY

DISCLAIMER/ NOTES:

1. Contours are based on finished design levels and are subject to construction and Council certification and therefore should not be considered as final or as-built.
2. location of utility services including but not limited to power, water, sewer, communications and gas are subject to construction and supply authority certification and therefore should not be considered as final or as-built.
3. survey information such as boundary dimensions and areas, easements etc are subject to final survey. Purchasers should refer to the deposited plan and 88B instrument contained in the contract for sale of land for further detailed information.
4. Bushfire and geotechnical classification are provided for convenience. Purchasers should refer to referenced detail specialist reports.
5. This preliminary site analysis plan has been collated from various sources of design information and is provided for convenience to assist purchasers in obtaining quotations/ tenders for dwelling construction.
6. This document does not form part of the contract of sale of the land.
7. Anticipated site classification - H1 class (to be confirmed at completion of construction).

(KA) - EASEMENT TO DRAIN WATER 2 WIDE
 (KB) - RESTRICTION ON THE USE OF LAND 0.9 WIDE
 (KC) - EASEMENT FOR SIGNAGE 1.5 WIDE
 (KD) - EASEMENT FOR PUBLIC ART 2.5 WIDE
 (KF) - ASSET PROTECTION EASEMENT 5 WIDE

REVISION/S: HD27 STAGE 5 MARKETING r1
 DATE: 20th May 2020
 BY: ACOR CONSULTANTS PTY LTD



MASTER PLAN



STAGE PLAN



PRELIMINARY SITE ANALYSIS PLAN

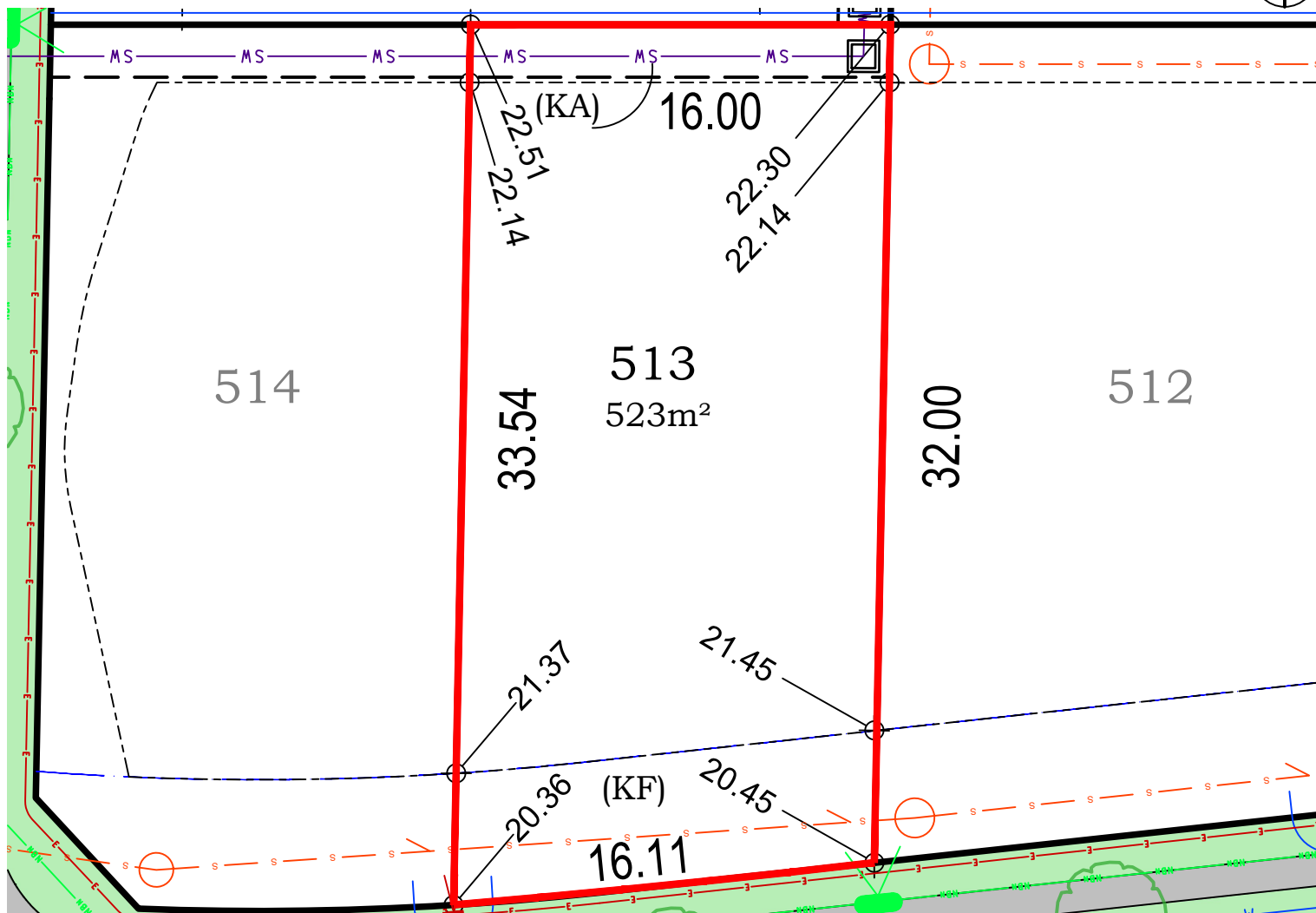

LEGEND:

- BATTER INTERFACE
- RETAINING WALL
- STORMWATER PIT
- SV — STORMWATER PIPE
- S — SEWERMAIN
- S — SEWER MAINTENANCE STRUCTURE
- S — SEWER JUNCTION
- W — WATERMAIN
- O X — HYDRANT, STOP VALVE
- NBN — TELSTRA/ NBN
- NBN — TELSTRA/ NBN PIT
- E — UNDER GROUND POWER
- E — ELECTRICITY PILLAR
- E — ELECTRICAL SUBSTATION
- E — ELECTRICAL EASEMENT
- E — LIGHT POLE
- R — RESTRICTION ON THE USE OF LAND 0.9 WIDE
- S — STREET TREES
- A — ASSET PROTECTION ZONE BDY

DISCLAIMER/ NOTES:

1. Contours are based on finished design levels and are subject to construction and Council certification and therefore should not be considered as final or as-built.
2. Location of utility services including but not limited to power, water, sewer, communications and gas are subject to construction and supply authority certification and therefore should not be considered as final or as-built.
3. Survey information such as boundary dimensions and areas, easements etc are subject to final survey. Purchasers should refer to the deposited plan and 88B instrument contained in the contract for sale of land for further detailed information.
4. Bushfire and geotechnical classification are provided for convenience. Purchasers should refer to referenced detail specialist reports.
5. This preliminary site analysis plan has been collated from various sources of design information and is provided for convenience to assist purchasers in obtaining quotations/ tenders for dwelling construction.
6. This document does not form part of the contract of sale of the land.
7. Anticipated site classification - H1 class (to be confirmed at completion of construction).

(KA) - EASEMENT TO DRAIN WATER 2 WIDE
 (KB) - RESTRICTION ON THE USE OF LAND 0.9 WIDE
 (KC) - EASEMENT FOR SIGNAGE 1.5 WIDE
 (KD) - EASEMENT FOR PUBLIC ART 2.5 WIDE
 (KF) - ASSET PROTECTION EASEMENT 5 WIDE

REVISION/S: HD27 STAGE 5 MARKETING r1
 DATE: 26th May 2020
 BY: ACOR CONSULTANTS PTY LTD

LOT 514, ROAD 09 EDGEWORTH



BRUSH CREEK
— LAKE MACQUARIE —

MASTER PLAN



STAGE PLAN



PRELIMINARY SITE ANALYSIS PLAN

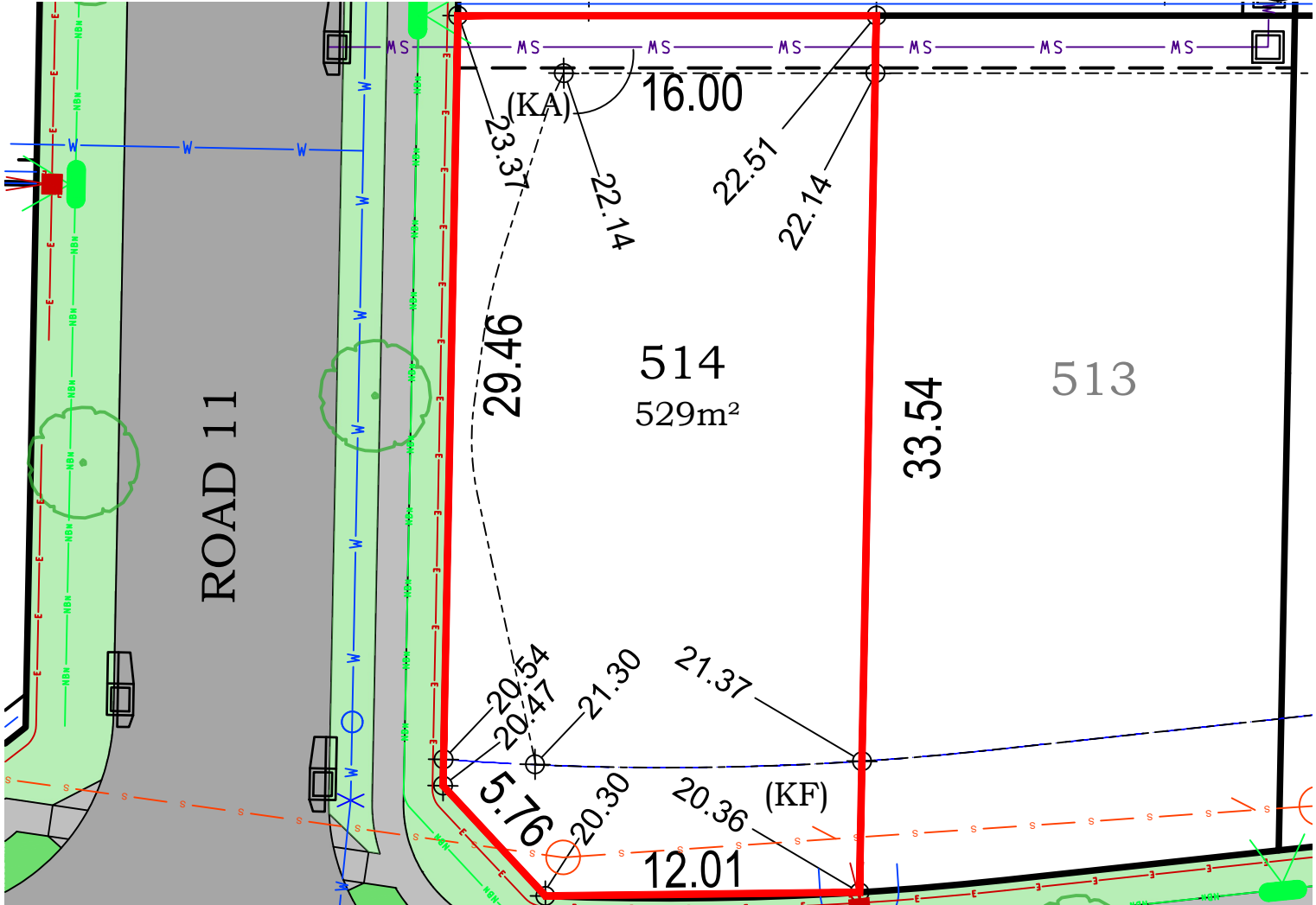

LEGEND:

- BATTER INTERFACE
- RETAINING WALL
- STORMWATER PIT
- SV --- STORMWATER PIPE
- S --- SEWERMAIN
- O --- SEWER MAINTENANCE STRUCTURE
- S --- SEWER JUNCTION
- W --- WATERMAIN
- O X --- HYDRANT, STOP VALVE
- NBN --- TELSTRA/ NBN
- NBN PIT --- TELSTRA/ NBN PIT
- E --- UNDER GROUND POWER
- E --- ELECTRICITY PILLAR
- E --- ELECTRICAL SUBSTATION
- E --- ELECTRICAL EASEMENT
- E --- LIGHT POLE
- E --- RESTRICTION ON THE USE OF LAND 0.9 WIDE
- S --- STREET TREES
- S --- ASSET PROTECTION ZONE BDY

DISCLAIMER/ NOTES:

1. Contours are based on finished design levels and are subject to construction and Council certification and therefore should not be considered as final or as-built.
2. Location of utility services including but not limited to power, water, sewer, communications and gas are subject to construction and supply authority certification and therefore should not be considered as final or as-built.
3. Survey information such as boundary dimensions and areas, easements etc are subject to final survey. Purchasers should refer to the deposited plan and 88B instrument contained in the contract for sale of land for further detailed information.
4. Bushfire and geotechnical classification are provided for convenience. Purchasers should refer to referenced detail specialist reports.
5. This preliminary site analysis plan has been collated from various sources of design information and is provided for convenience to assist purchasers in obtaining quotations/ tenders for dwelling construction.
6. This document does not form part of the contract of sale of the land.
7. Anticipated site classification - H1 class (to be confirmed at completion of construction).

(KA) - EASEMENT TO DRAIN WATER 2 WIDE
(KB) - RESTRICTION ON THE USE OF LAND 0.9 WIDE
(KC) - EASEMENT FOR SIGNAGE 1.5 WIDE
(KD) - EASEMENT FOR PUBLIC ART 2.5 WIDE
(KF) - ASSET PROTECTION EASEMENT 5 WIDE

REVISION/S: HD27 STAGE 5 MARKETING r1
DATE: 26th May 2020
BY: ACOR CONSULTANTS PTY LTD

brushcreek.com.au



LOT 515, ROAD 11 EDGEWORTH



BRUSH CREEK
— LAKE MACQUARIE —

MASTER PLAN



STAGE PLAN



PRELIMINARY SITE ANALYSIS PLAN

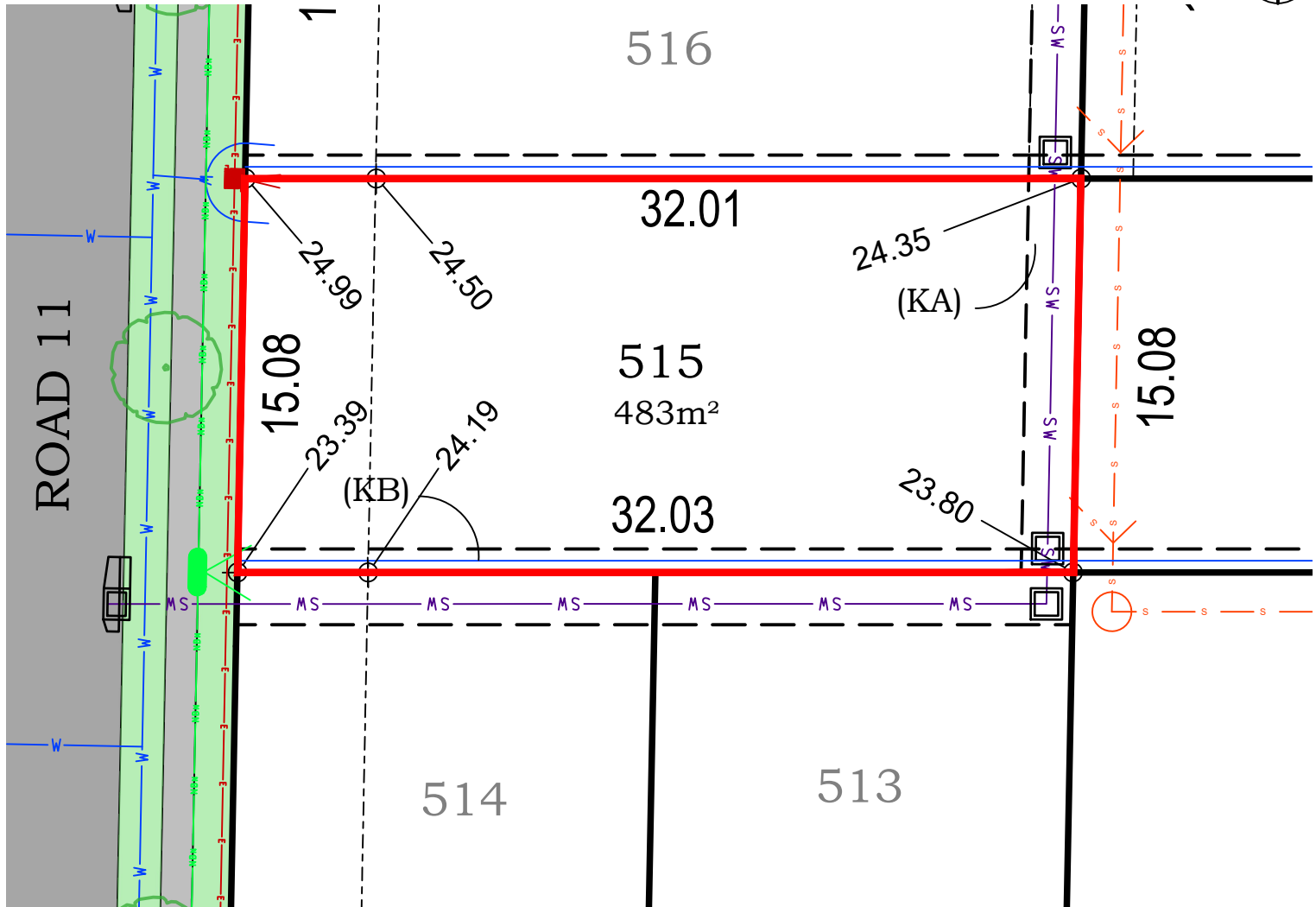

LEGEND:

- BATTER INTERFACE
- RETAINING WALL
- STORMWATER PIT
- SV --- STORMWATER PIPE
- S --- SEWERMAIN
- O --- SEWER MAINTENANCE STRUCTURE
- S --- SEWER JUNCTION
- W --- WATERMAIN
- O X --- HYDRANT, STOP VALVE
- NBN --- TELSTRA/ NBN
- NBN PIT --- TELSTRA/ NBN PIT
- E --- UNDER GROUND POWER
- E --- ELECTRICITY PILLAR
- E --- ELECTRICAL SUBSTATION
- E --- ELECTRICAL EASEMENT
- E --- LIGHT POLE
- E --- RESTRICTION ON THE USE OF LAND 0.9 WIDE
- S --- STREET TREES
- S --- ASSET PROTECTION ZONE BDY

DISCLAIMER/ NOTES:

- Contours are based on finished design levels and are subject to construction and Council certification and therefore should not be considered as final or as-built.
- Location of utility services including but not limited to power, water, sewer, communications and gas are subject to construction and supply authority certification and therefore should not be considered as final or as-built.
- Survey information such as boundary dimensions and areas, easements etc are subject to final survey. Purchasers should refer to the deposited plan and 88B instrument contained in the contract for sale of land for further detailed information.
- Bushfire and geotechnical classification are provided for convenience. Purchasers should refer to referenced detail specialist reports.
- This preliminary site analysis plan has been collated from various sources of design information and is provided for convenience to assist purchasers in obtaining quotations/ tenders for dwelling construction.
- This document does not form part of the contract of sale of the land.
- Anticipated site classification - H1 class (to be confirmed at completion of construction).

(KA) - EASEMENT TO DRAIN WATER 2 WIDE
(KB) - RESTRICTION ON THE USE OF LAND 0.9 WIDE
(KC) - EASEMENT FOR SIGNAGE 1.5 WIDE
(KD) - EASEMENT FOR PUBLIC ART 2.5 WIDE
(KF) - ASSET PROTECTION EASEMENT 20 WIDE

REVISION/S: HD27 STAGE 5 MARKETING r1
DATE: 20th May 2020
BY: ACOR CONSULTANTS PTY LTD

brushcreek.com.au



LOT 516, ROAD 11 EDGEWORTH



BRUSH CREEK
— LAKE MACQUARIE —

MASTER PLAN



STAGE PLAN



PRELIMINARY SITE ANALYSIS PLAN

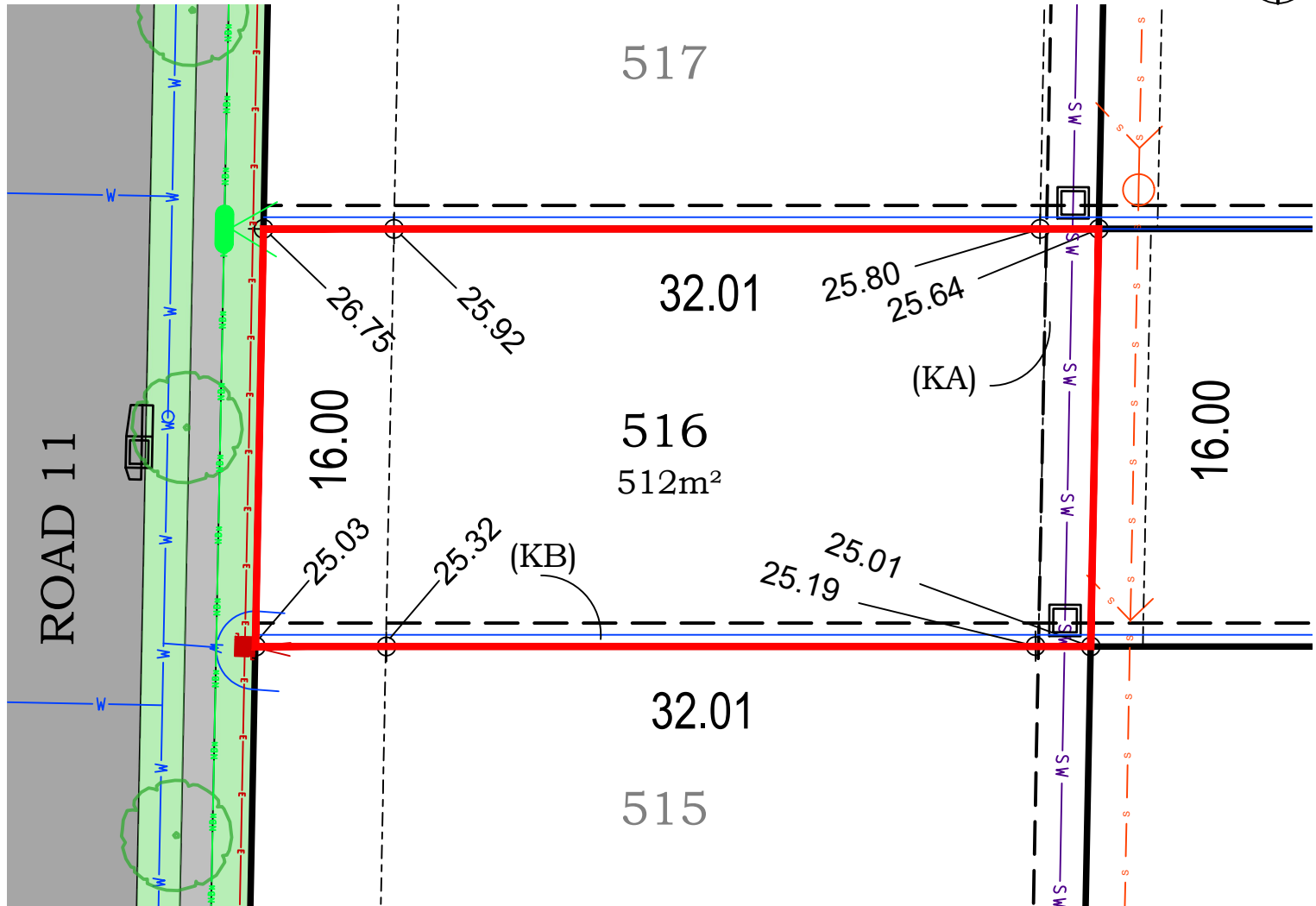

LEGEND:

- BATTER INTERFACE
- RETAINING WALL
- STORMWATER PIT
- SV --- STORMWATER PIPE
- S --- SEWERMAIN
- S --- SEWER MAINTENANCE STRUCTURE
- S --- SEWER JUNCTION
- W --- WATERMAIN
- O X --- HYDRANT, STOP VALVE
- NBN --- TELSTRA/ NBN
- NBN PIT --- TELSTRA/ NBN PIT
- E --- UNDER GROUND POWER
- E --- ELECTRICITY PILLAR
- E --- ELECTRICAL SUBSTATION
- E --- ELECTRICAL EASEMENT
- E --- LIGHT POLE
- E --- RESTRICTION ON THE USE OF LAND 0.9 WIDE
- E --- STREET TREES
- E --- ASSET PROTECTION ZONE BDY

DISCLAIMER/ NOTES:

1. Contours are based on finished design levels and are subject to construction and Council certification and therefore should not be considered as final or as-built.
2. Location of utility services including but not limited to power, water, sewer, communications and gas are subject to construction and supply authority certification and therefore should not be considered as final or as-built.
3. Survey information such as boundary dimensions and areas, easements etc are subject to final survey. Purchasers should refer to the deposited plan and 88B instrument contained in the contract for sale of land for further detailed information.
4. Bushfire and geotechnical classification are provided for convenience. Purchasers should refer to referenced detail specialist reports.
5. This preliminary site analysis plan has been collated from various sources of design information and is provided for convenience to assist purchasers in obtaining quotations/ tenders for dwelling construction.
6. This document does not form part of the contract of sale of the land.
7. Anticipated site classification - H1 class (to be confirmed at completion of construction).

(KA) - EASEMENT TO DRAIN WATER 2 WIDE
(KB) - RESTRICTION ON THE USE OF LAND 0.9 WIDE
(KC) - EASEMENT FOR SIGNAGE 1.5 WIDE
(KD) - EASEMENT FOR PUBLIC ART 2.5 WIDE
(KF) - ASSET PROTECTION EASEMENT 20 WIDE

REVISION/S: HD27 STAGE 5 MARKETING r1
DATE: 20th May 2020
BY: ACOR CONSULTANTS PTY LTD

brushcreek.com.au



LOT 517, ROAD 11 EDGEWORTH



BRUSH CREEK
— LAKE MACQUARIE —

MASTER PLAN



STAGE PLAN



PRELIMINARY SITE ANALYSIS PLAN

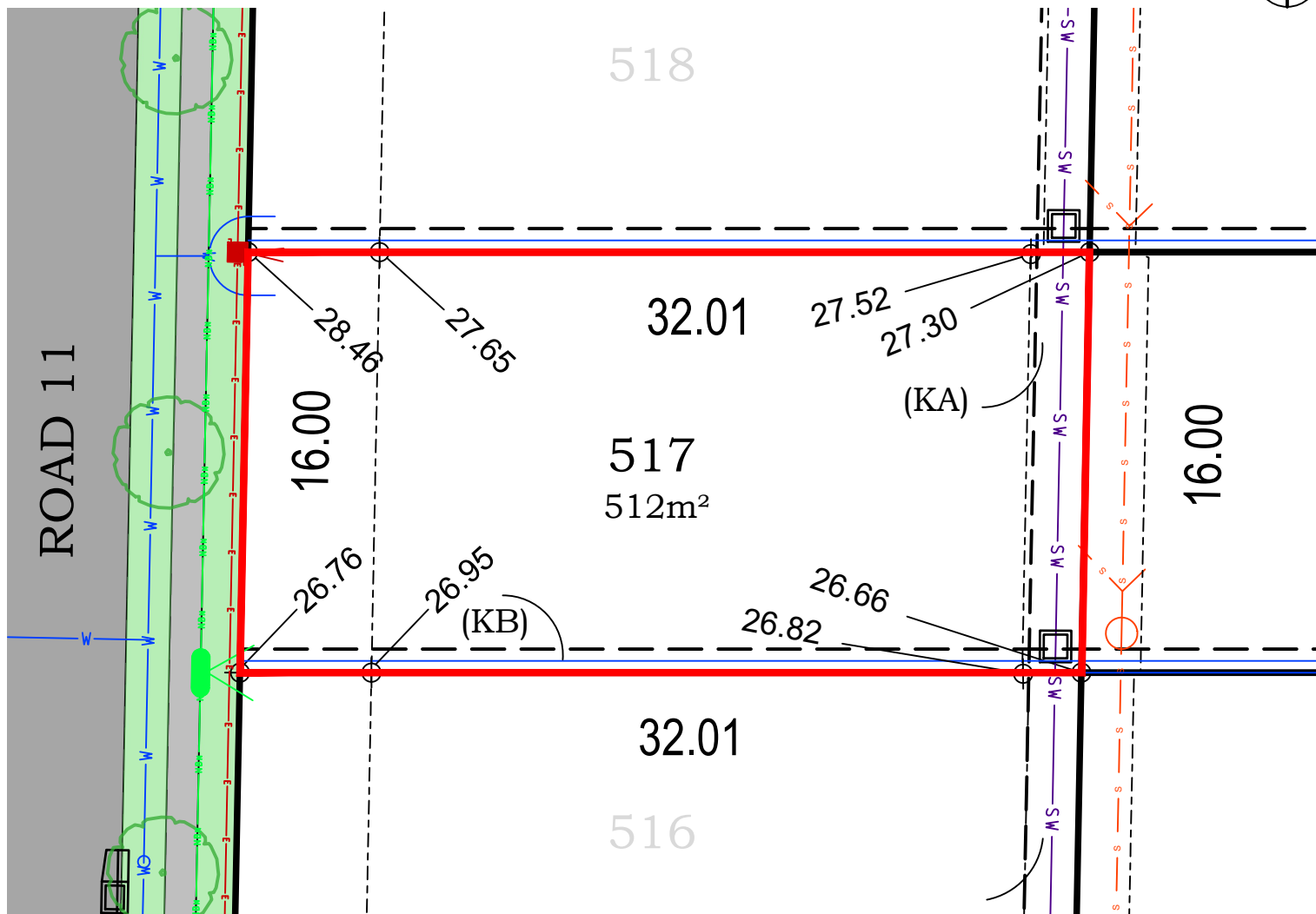

DISCLAIMER/ NOTES:

- Contours are based on finished design levels and are subject to construction and Council certification and therefore should not be considered as final or as-built.
- Location of utility services including but not limited to power, water, sewer, communications and gas are subject to construction and supply authority certification and therefore should not be considered as final or as-built.
- Survey information such as boundary dimensions and areas, easements etc are subject to final survey. Purchasers should refer to the deposited plan and 88B instrument contained in the contract for sale of land for further detailed information.
- Bushfire and geotechnical classification are provided for convenience. Purchasers should refer to referenced detail specialist reports.
- This preliminary site analysis plan has been collated from various sources of design information and is provided for convenience to assist purchasers in obtaining quotations/ tenders for dwelling construction.
- This document does not form part of the contract of sale of the land.
- Anticipated site classification - H1 class (to be confirmed at completion of construction).

(KA) - EASEMENT TO DRAIN WATER 2 WIDE
(KB) - RESTRICTION ON THE USE OF LAND 0.9 WIDE
(KC) - EASEMENT FOR SIGNAGE 1.5 WIDE
(KD) - EASEMENT FOR PUBLIC ART 2.5 WIDE
(KF) - ASSET PROTECTION EASEMENT 20 WIDE

REVISION/S: HD27 STAGE 5 MARKETING r1
DATE: 20th May 2020
BY: ACOR CONSULTANTS PTY LTD

brushcreek.com.au



A QUALITY
MCCLOY
GROUP
PROJECT



MASTER PLAN



STAGE PLAN



PRELIMINARY SITE ANALYSIS PLAN

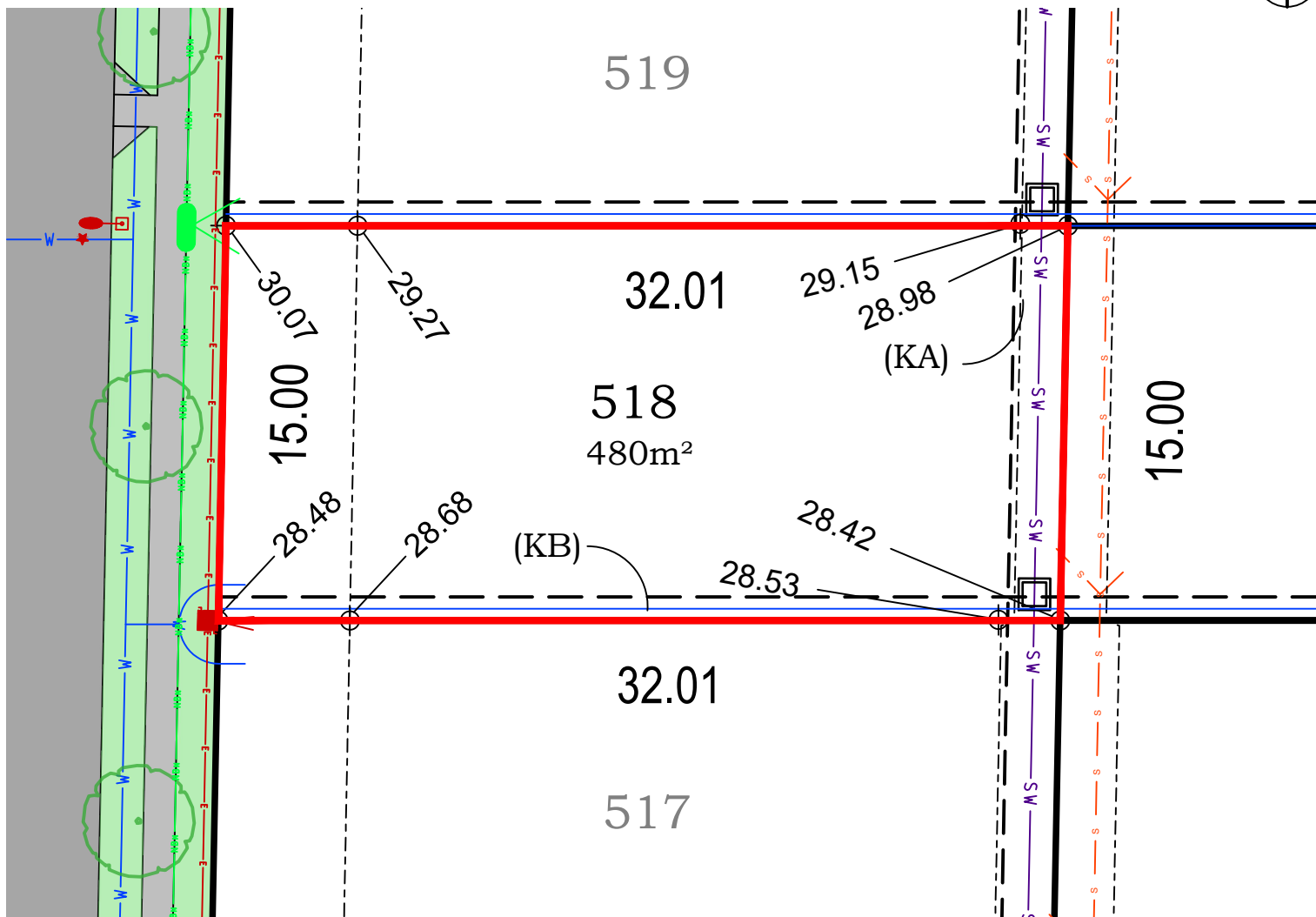

LEGEND:

- BATTER INTERFACE
- RETAINING WALL
- STORMWATER PIT
- SV — STORMWATER PIPE
- S — SEWERMAIN
- S — SEWER MAINTENANCE STRUCTURE
- S — SEWER JUNCTION
- W — WATERMAIN
- O X — HYDRANT, STOP VALVE
- NBN — TELSTRA/ NBN
- NBN — TELSTRA/ NBN PIT
- E — UNDER GROUND POWER
- E — ELECTRICITY PILLAR
- E — ELECTRICAL SUBSTATION
- E — ELECTRICAL EASEMENT
- E — LIGHT POLE
- E — RESTRICTION ON THE USE OF LAND 0.9 WIDE
- E — STREET TREES
- E — ASSET PROTECTION ZONE BDY

DISCLAIMER/ NOTES:

- Contours are based on finished design levels and are subject to construction and Council certification and therefore should not be considered as final or as-built.
- Location of utility services including but not limited to power, water, sewer, communications and gas are subject to construction and supply authority certification and therefore should not be considered as final or as-built.
- Survey information such as boundary dimensions and areas, easements etc are subject to final survey. Purchasers should refer to the deposited plan and 88B instrument contained in the contract for sale of land for further detailed information.
- Bushfire and geotechnical classification are provided for convenience. Purchasers should refer to referenced detail specialist reports.
- This preliminary site analysis plan has been collated from various sources of design information and is provided for convenience to assist purchasers in obtaining quotations/ tenders for dwelling construction.
- This document does not form part of the contract of sale of the land.
- Anticipated site classification - H1 class (to be confirmed at completion of construction).

(KA) - EASEMENT TO DRAIN WATER 2 WIDE
 (KB) - RESTRICTION ON THE USE OF LAND 0.9 WIDE
 (KC) - EASEMENT FOR SIGNAGE 1.5 WIDE
 (KD) - EASEMENT FOR PUBLIC ART 2.5 WIDE
 (KF) - ASSET PROTECTION EASEMENT 20 WIDE

REVISION/S: HD27 STAGE 5 MARKETING r1
 DATE: 26th May 2020
 BY: ACOR CONSULTANTS PTY LTD

LOT 519, ROAD 11 EDGEWORTH



BRUSH CREEK
— LAKE MACQUARIE —

MASTER PLAN



STAGE PLAN



PRELIMINARY SITE ANALYSIS PLAN

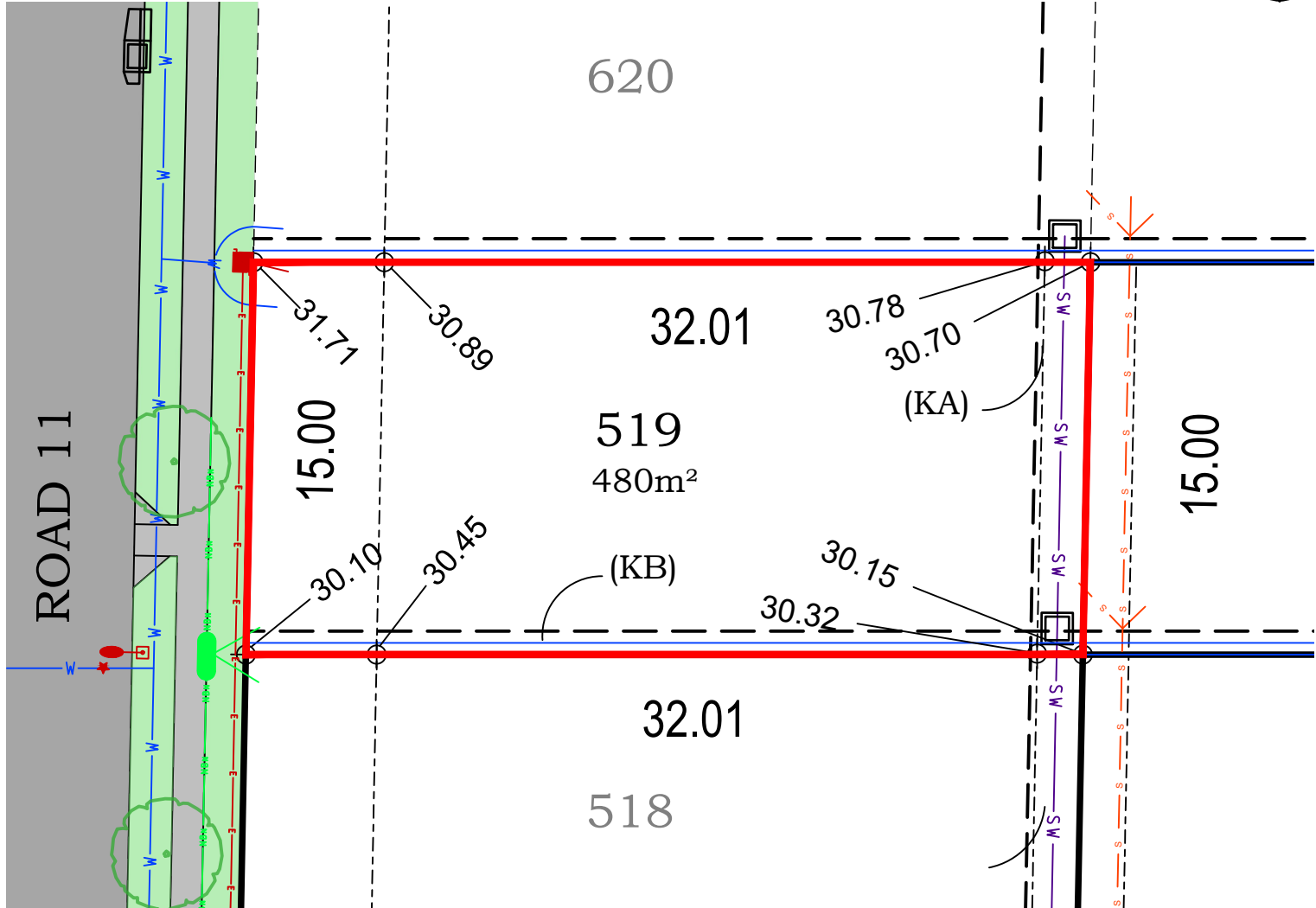

DISCLAIMER/ NOTES:

1. Contours are based on finished design levels and are subject to construction and Council certification and therefore should not be considered as final or as-built.
2. Location of utility services including but not limited to power, water, sewer, communications and gas are subject to construction and supply authority certification and therefore should not be considered as final or as-built.
3. Survey information such as boundary dimensions and areas, easements etc are subject to final survey. Purchasers should refer to the deposited plan and 88B instrument contained in the contract for sale of land for further detailed information.
4. Bushfire and geotechnical classification are provided for convenience. Purchasers should refer to referenced detail specialist reports.
5. This preliminary site analysis plan has been collated from various sources of design information and is provided for convenience to assist purchasers in obtaining quotations/ tenders for dwelling construction.
6. This document does not form part of the contract of sale of the land.
7. Anticipated site classification - H1 class (to be confirmed at completion of construction).

(KA) - EASEMENT TO DRAIN WATER 2 WIDE
(KB) - RESTRICTION ON THE USE OF LAND 0.9 WIDE
(KC) - EASEMENT FOR SIGNAGE 1.5 WIDE
(KD) - EASEMENT FOR PUBLIC ART 2.5 WIDE
(KF) - ASSET PROTECTION EASEMENT 20 WIDE

REVISION/S: HD27 STAGE 5 MARKETING r1
DATE: 26th May 2020
BY: ACOR CONSULTANTS PTY LTD

brushcreek.com.au



LOT 520, ROAD 10 EDGEWORTH



BRUSH CREEK
— LAKE MACQUARIE —

MASTER PLAN



STAGE PLAN



PRELIMINARY SITE ANALYSIS PLAN

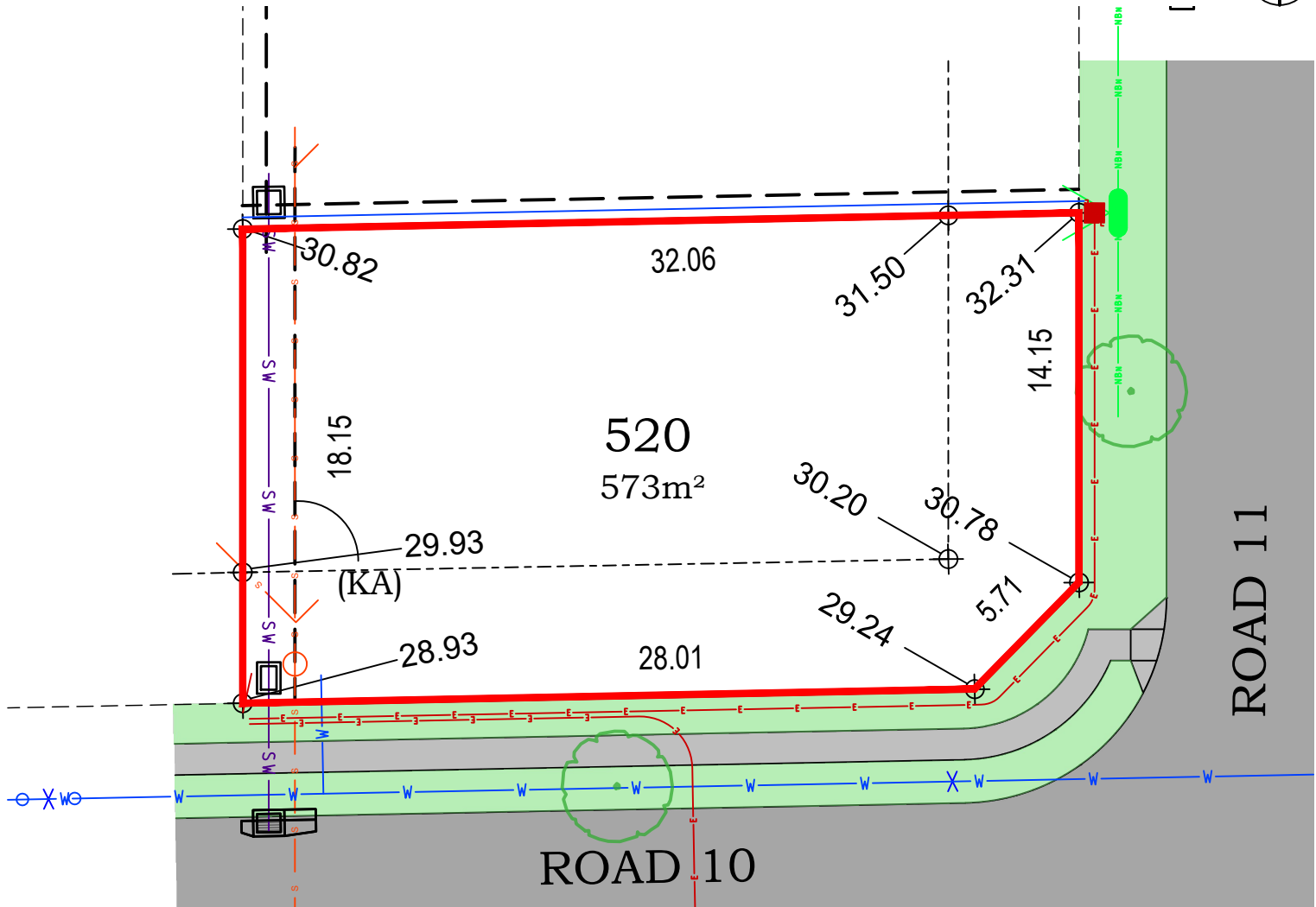

LEGEND:

- BATTER INTERFACE
- RETAINING WALL
- STORMWATER PIT
- SV — STORMWATER PIPE
- S — SEWERMAIN
- S — SEWER MAINTENANCE STRUCTURE
- S — SEWER JUNCTION
- W — WATERMAIN
- O X — HYDRANT, STOP VALVE
- NBN — TELSTRA/ NBN
- NBN — TELSTRA/ NBN PIT
- E — UNDER GROUND POWER
- E — ELECTRICITY PILLAR
- E — ELECTRICAL SUBSTATION
- E — ELECTRICAL EASEMENT
- E — LIGHT POLE
- E — RESTRICTION ON THE USE OF LAND 0.9 WIDE
- E — STREET TREES
- E — ASSET PROTECTION ZONE BDY

DISCLAIMER/ NOTES:

1. Contours are based on finished design levels and are subject to construction and Council certification and therefore should not be considered as final or as-built.
2. Location of utility services including but not limited to power, water, sewer, communications and gas are subject to construction and supply authority certification and therefore should not be considered as final or as-built.
3. Survey information such as boundary dimensions and areas, easements etc are subject to final survey. Purchasers should refer to the deposited plan and 88B instrument contained in the contract for sale of land for further detailed information.
4. Bushfire and geotechnical classification are provided for convenience. Purchasers should refer to referenced detail specialist reports.
5. This preliminary site analysis plan has been collated from various sources of design information and is provided for convenience to assist purchasers in obtaining quotations/ tenders for dwelling construction.
6. This document does not form part of the contract of sale of the land.
7. Anticipated site classification - H1 class (to be confirmed at completion of construction).

(KA) - EASEMENT TO DRAIN WATER 2 WIDE
(KB) - RESTRICTION ON THE USE OF LAND 0.9 WIDE
(KC) - EASEMENT FOR SIGNAGE 1.5 WIDE
(KD) - EASEMENT FOR PUBLIC ART 2.5 WIDE
(KF) - ASSET PROTECTION EASEMENT 20 WIDE

REVISION/S: HD27 STAGE 5 MARKETING r1
DATE: 26th May 2020
BY: ACOR CONSULTANTS PTY LTD

brushcreek.com.au



LOT 521, ROAD 10 EDGEWORTH



BRUSH CREEK
— LAKE MACQUARIE —

MASTER PLAN



STAGE PLAN



PRELIMINARY SITE ANALYSIS PLAN

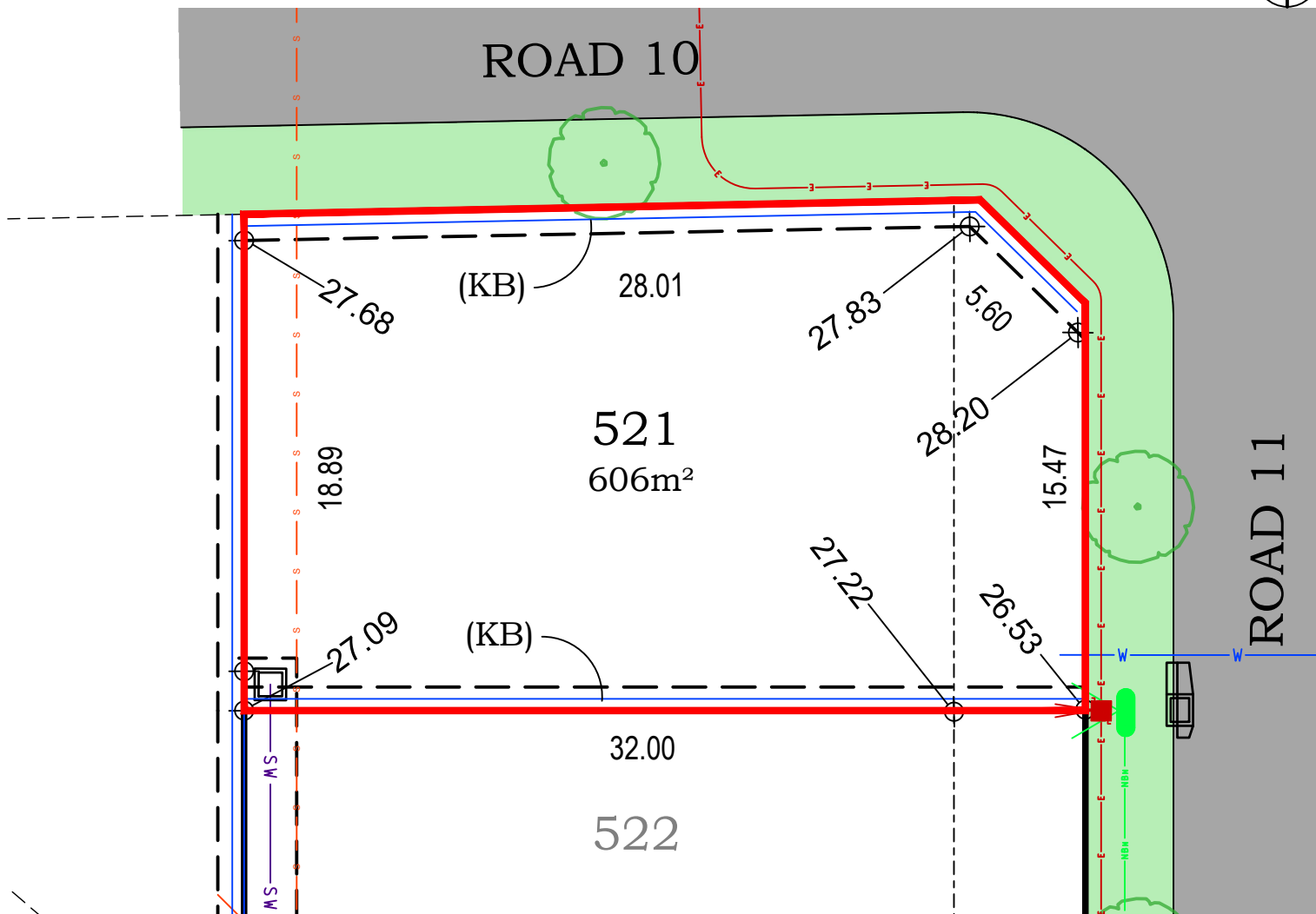

- LEGEND:**
- BATTER INTERFACE
 - RETAINING WALL
 - STORMWATER PIT
 - SV --- STORMWATER PIPE
 - S --- SEWERMAIN
 - O --- SEWER MAINTENANCE STRUCTURE
 - S --- SEWER JUNCTION
 - W --- WATERMAIN
 - O X --- HYDRANT, STOP VALVE
 - NBN --- TELSTRA/ NBN
 - NBN --- TELSTRA/ NBN PIT
 - E --- UNDER GROUND POWER
 - E --- ELECTRICITY PILLAR
 - E --- ELECTRICAL SUBSTATION
 - E --- ELECTRICAL EASEMENT
 - E --- LIGHT POLE
 - E --- RESTRICTION ON THE USE OF LAND 0.9 WIDE
 - E --- STREET TREES
 - E --- ASSET PROTECTION ZONE BDY

DISCLAIMER/ NOTES:

1. Contours are based on finished design levels and are subject to construction and Council certification and therefore should not be considered as final or as-built.
2. location of utility services including but not limited to power, water, sewer, communications and gas are subject to construction and supply authority certification and therefore should not be considered as final or as-built.
3. survey information such as boundary dimensions and areas, easements etc are subject to final survey. Purchasers should refer to the deposited plan and 88B instrument contained in the contract for sale of land for further detailed information.
4. Bushfire and geotechnical classification are provided for convenience. Purchasers should refer to referenced detail specialist reports.
5. This preliminary site analysis plan has been collated from various sources of design information and is provided for convenience to assist purchasers in obtaining quotations/ tenders for dwelling construction.
6. This document does not form part of the contract of sale of the land.
7. Anticipated site classification - H1 class (to be confirmed at completion of construction).

(KA) - EASEMENT TO DRAIN WATER 2 WIDE
(KB) - RESTRICTION ON THE USE OF LAND 0.9 WIDE
(KC) - EASEMENT FOR SIGNAGE 1.5 WIDE
(KD) - EASEMENT FOR PUBLIC ART 2.5 WIDE
(KF) - ASSET PROTECTION EASEMENT 20 WIDE

REVISION/S: HD27 STAGE 5 MARKETING r1
DATE: 26th May 2020
BY: ACOR CONSULTANTS PTY LTD

brushcreek.com.au

Mc
McCLOY GROUP

A QUALITY
MCCLOY
GROUP
PROJECT

LOT 522, ROAD 11 EDGEWORTH

MASTER PLAN



STAGE PLAN



PRELIMINARY SITE ANALYSIS PLAN

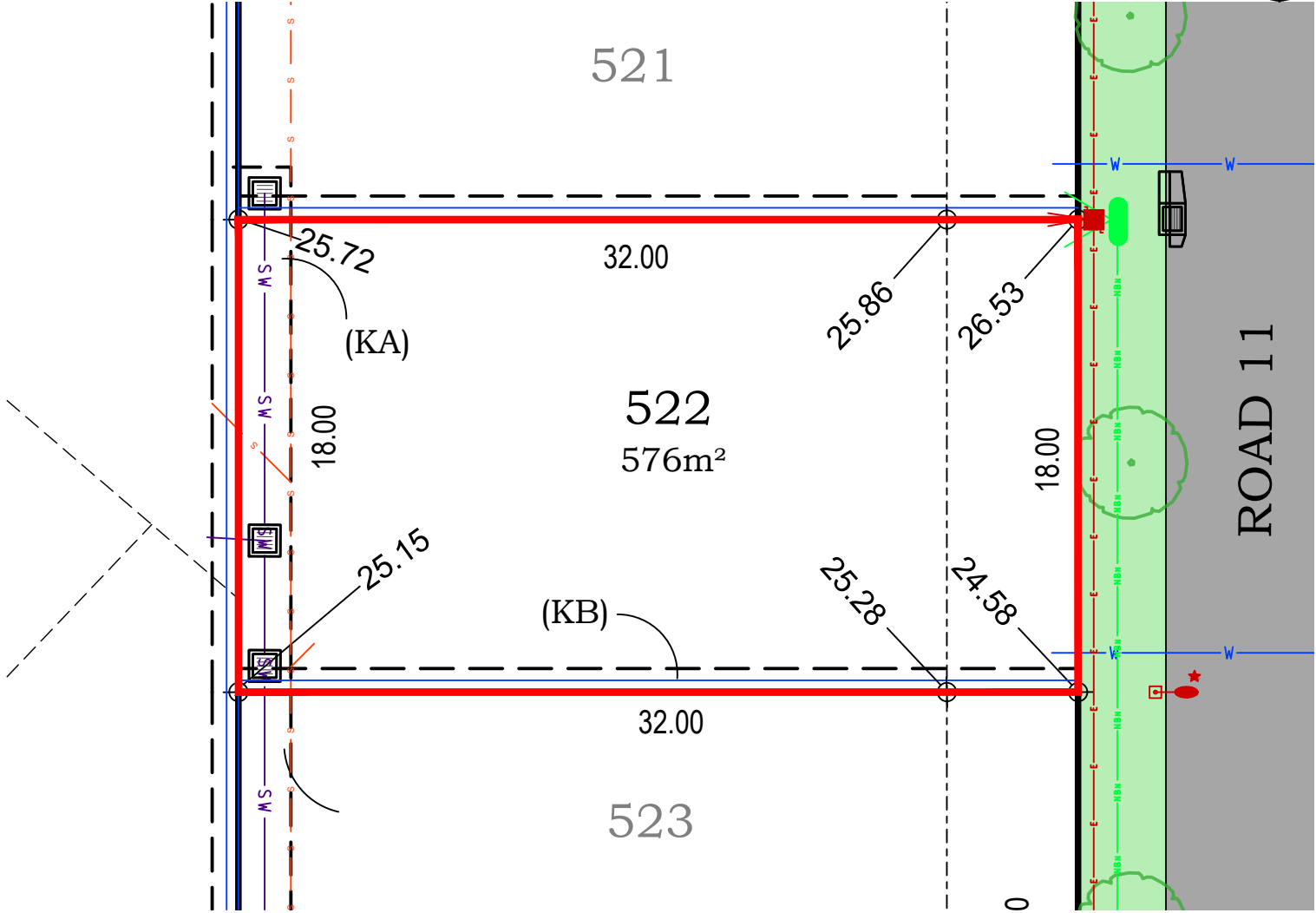

- LEGEND:**
- BATTER INTERFACE
 - RETAINING WALL
 - STORMWATER PIT
 - SV STORMWATER PIPE
 - S SEWERMAIN
 - SEWER MAINTENANCE STRUCTURE
 - S SEWER JUNCTION
 - W WATERMAIN
 - HYDRANT, STOP VALVE
 - NBN TELSTRA/ NBN
 - TELSTRA/ NBN PIT
 - E UNDER GROUND POWER
 - ELECTRICITY PILLAR
 - ELECTRICAL SUBSTATION
 - ELECTRICAL EASEMENT
 - LIGHT POLE
 - RESTRICTION ON THE USE OF LAND 0.9 WIDE
 - STREET TREES
 - ASSET PROTECTION ZONE BDY

DISCLAIMER/ NOTES:

- Contours are based on finished design levels and are subject to construction and Council certification and therefore should not be considered as final or as-built.
- location of utility services including but not limited to power, water, sewer, communications and gas are subject to construction and supply authority certification and therefore should not be considered as final or as-built.
- survey information such as boundary dimensions and areas, easements etc are subject to final survey. Purchasers should refer to the deposited plan and 88B instrument contained in the contract for sale of land for further detailed information.
- Bushfire and geotechnical classification are provided for convenience. Purchasers should refer to referenced detail specialist reports.
- This preliminary site analysis plan has been collated from various sources of design information and is provided for convenience to assist purchasers in obtaining quotations/ tenders for dwelling construction.
- This document does not form part of the contract of sale of the land.
- Anticipated site classification - H1 class (to be confirmed at completion of construction).

- (KA) - EASEMENT TO DRAIN WATER 2 WIDE
(KB) - RESTRICTION ON THE USE OF LAND 0.9 WIDE
(KC) - EASEMENT FOR SIGNAGE 1.5 WIDE
(KD) - EASEMENT FOR PUBLIC ART 2.5 WIDE
(KF) - ASSET PROTECTION EASEMENT 20 WIDE

REVISION/S: HD27 STAGE 5 MARKETING r1
DATE: 26th May 2020
BY: ACOR CONSULTANTS PTY LTD

LOT 523, ROAD 11 EDGEWORTH

MASTER PLAN



STAGE PLAN



PRELIMINARY SITE ANALYSIS PLAN

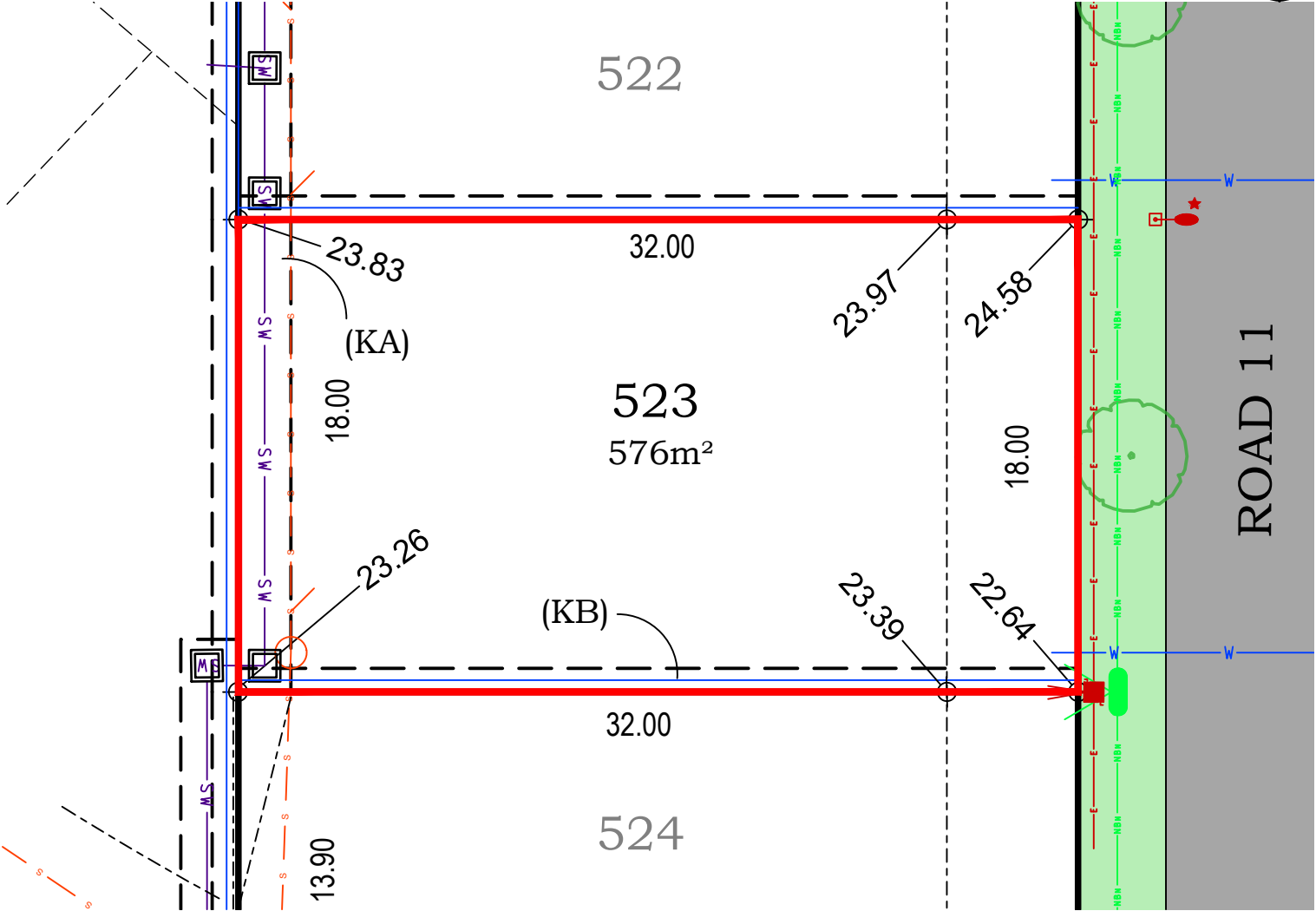

- LEGEND:**
- BATTER INTERFACE
 - RETAINING WALL
 - STORMWATER PIT
 - STORMWATER PIPE
 - SEWERMAIN
 - SEWER MAINTENANCE STRUCTURE
 - SEWER JUNCTION
 - WATERMAIN
 - HYDRANT, STOP VALVE
 - TELSTRA/ NBN
 - TELSTRA/ NBN PIT
 - UNDER GROUND POWER
 - ELECTRICITY PILLAR
 - ELECTRICAL SUBSTATION
 - ELECTRICAL EASEMENT
 - LIGHT POLE
 - RESTRICTION ON THE USE OF LAND 0.9 WIDE
 - STREET TREES
 - ASSET PROTECTION ZONE BDY

DISCLAIMER/ NOTES:

- Contours are based on finished design levels and are subject to construction and Council certification and therefore should not be considered as final or as-built.
- Location of utility services including but not limited to power, water, sewer, communications and gas are subject to construction and supply authority certification and therefore should not be considered as final or as-built.
- Survey information such as boundary dimensions and areas, easements etc are subject to final survey. Purchasers should refer to the deposited plan and 88B instrument contained in the contract for sale of land for further detailed information.
- Bushfire and geotechnical classification are provided for convenience. Purchasers should refer to referenced detail specialist reports.
- This preliminary site analysis plan has been collated from various sources of design information and is provided for convenience to assist purchasers in obtaining quotations/ tenders for dwelling construction.
- This document does not form part of the contract of sale of the land.
- Anticipated site classification - H1 class (to be confirmed at completion of construction).

(KA) - EASEMENT TO DRAIN WATER 2 WIDE
(KB) - RESTRICTION ON THE USE OF LAND 0.9 WIDE
(KC) - EASEMENT FOR SIGNAGE 1.5 WIDE
(KD) - EASEMENT FOR PUBLIC ART 2.5 WIDE
(KF) - ASSET PROTECTION EASEMENT 20 WIDE

REVISION/S: HD27 STAGE 5 MARKETING r1
DATE: 26th May 2020
BY: ACOR CONSULTANTS PTY LTD

